

## CONTACT US FIRST BEFORE MAKING ANY RETURNS TO THE RETAILER.

Visit **sauder.com/service** to order replacement parts, view video assembly tips, or chat with a live rep.  
Prefer the phone? Give us a ring at 1-800-523-3987.

Customer Service is available Monday-Friday - 9 a.m. to 5:30 p.m. EST (except holidays)

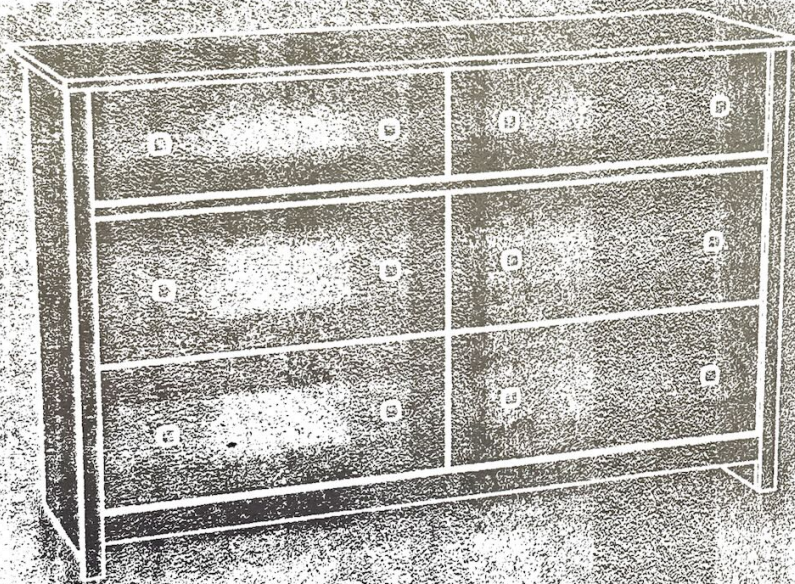

 **SAUDER**

Yes, you still have to  
dress yourself.

# Dresser

River Ranch Collection | **Model 430045**

Sauder.com

Share your journey!



**NOTE:** THIS INSTRUCTION  
BOOKLET CONTAINS **IMPORTANT**  
SAFETY INFORMATION.

PLEASE READ AND KEEP FOR  
FUTURE REFERENCE.

English pg 1-28  
Français pg 29-32  
Español pg 33-36

Lot # **569871**  
Purchased: \_\_\_\_\_

08/10/21



## Table of Contents

## Assembly Tools Required

Part Identification	3
Hardware Identification	4
Hardware Usage Guide	5
Assembly Steps	6-28
Français	29-32
Español	33-36
Safety	37-38
Warranty	39

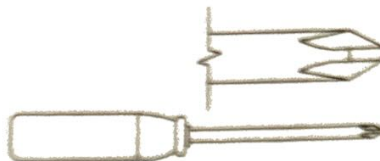

No. 2 Phillips Screwdriver  
Tip Shown Actual Size



Hammer  
Not actual size ☺

# Part Identification

Now you know  
our ABCs.



While not all parts are labeled, some of the parts will have a label or an inked letter on the edge to help distinguish similar parts from each other. Use this part identification to help identify similar parts.

A	RIGHT END (1)	D166	SMALL DRAWER BACK (2)	K	SMALL RIGHT DRAWER FRONT (1)
B	LEFT END (1)	D167	LARGE DRAWER BACK (4)	L	END MOLDING (2)
C	TOP (1)	D974	DRAWER BOTTOM (6)	M	SKIRT (1)
D	BOTTOM (1)	E	UPRIGHT (1)	M67	DRAWER BRACE (6)
D36	LARGE RIGHT DRAWER SIDE (4)	F	BACK (2)	N	DUST RAIL (1)
D37	LARGE LEFT DRAWER SIDE (4)	G	LARGE LEFT DRAWER FRONT (2)	O	LARGE BACK (1)
D44	SMALL RIGHT DRAWER SIDE (2)	H	LARGE RIGHT DRAWER FRONT (2)		
D45	SMALL LEFT DRAWER SIDE (2) 1 with label	J	SMALL LEFT DRAWER FRONT (1)		

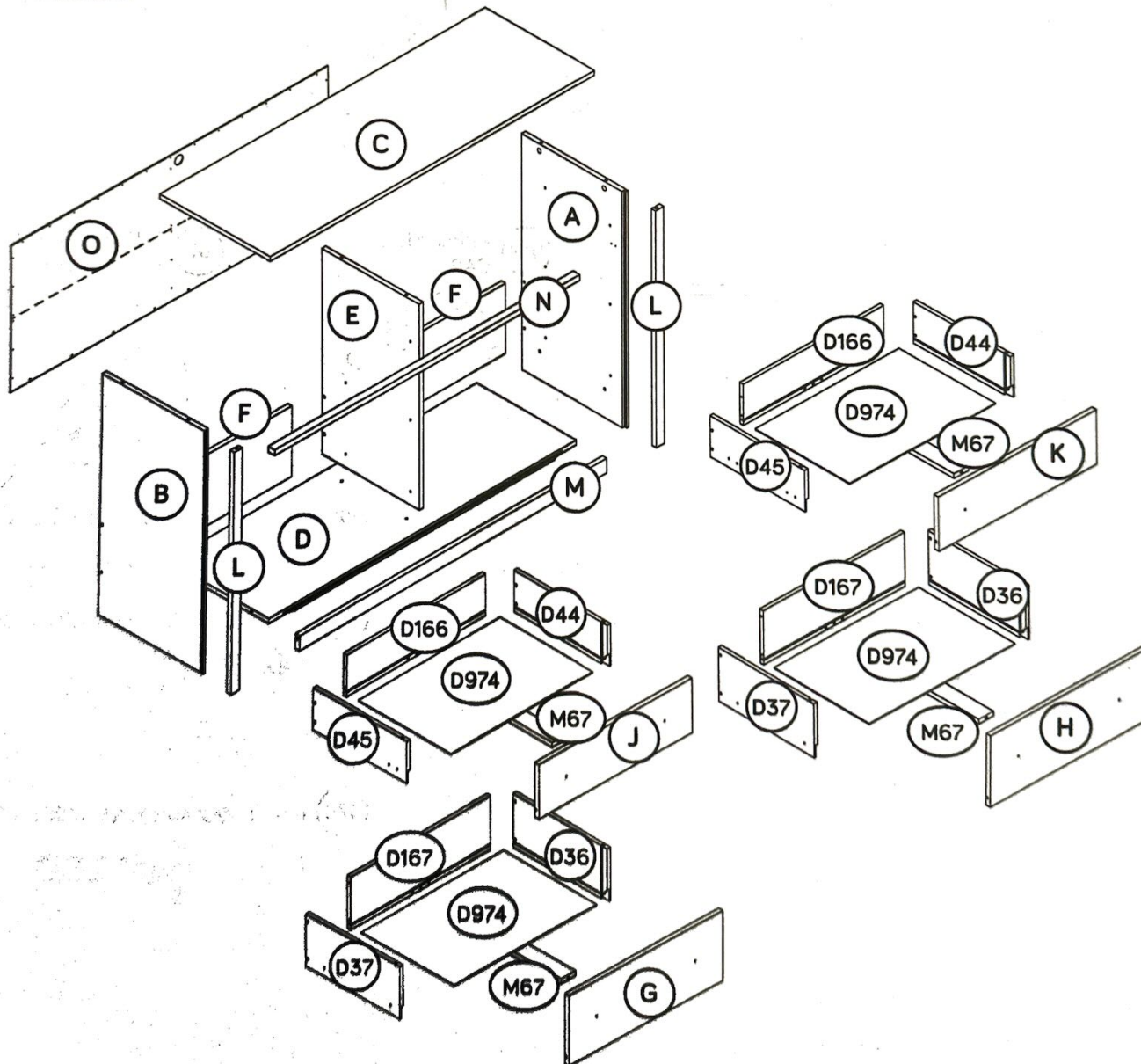

# Hardware Identification

† Screws are shown actual size. You may receive extra hardware with your unit.

**35AA** UNIVERSAL  
CABINET RAIL - 12



**35AC** DRAWER  
RIGHT - 6



**35AD** DRAWER  
LEFT - 6



**3E** FOOT - 1



**1F** HIDDEN CAM - 20



**2F** CAM DOWEL - 20



**1G** METAL  
BRACKET - 3

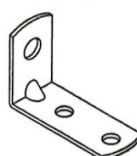

**8G** SMALL DRAWER  
FRONT BRACKET - 2

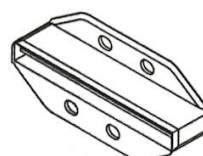

**9G** LARGE DRAWER  
FRONT BRACKET - 4

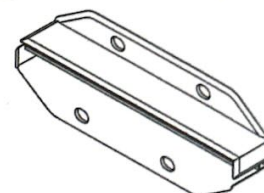

**199K** KNOB - 12



**1N** NAIL - 31

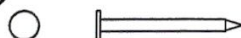

**91P** APPLIQUE  
CARD - 1

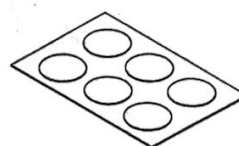

**97** FURNITURE TIPPING  
RESTRAINT KIT - 1

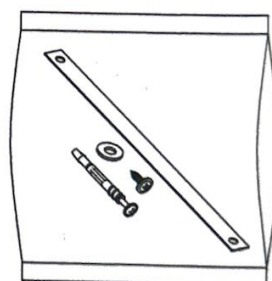

**1S** BLACK 9/16" LARGE HEAD SCREW - 41



**3S** GOLD 5/16" FLAT HEAD SCREW - 48



**30S** BLACK 1-9/16" FLAT HEAD SCREW - 30



**37S** BLACK 7/8" MACHINE SCREW - 12

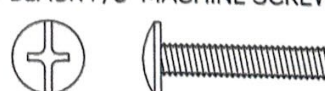

**113S** BLACK 1-15/16" FLAT HEAD SCREW - 6





# Hardware Usage Guide

## HOW TO USE A HIDDEN CAM & CAM DOWEL

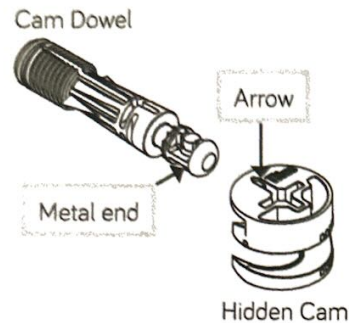

2. Insert the metal end of the CAM DOWEL into the HIDDEN CAM.

1. Push a HIDDEN CAM into the part. The arrow in the HIDDEN CAM must point toward the hole in the edge of the board.

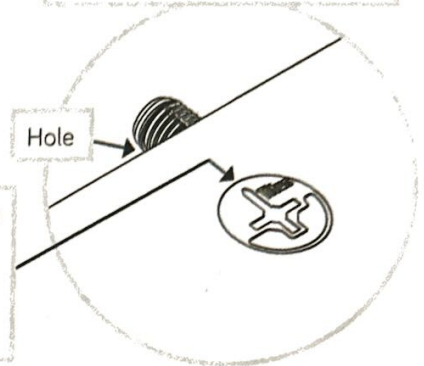

3. **Caution**  
Risk of damage or injury. HIDDEN CAMS must be completely tightened. HIDDEN CAMS that are not completely tightened may loosen, and parts may separate. To completely tighten:

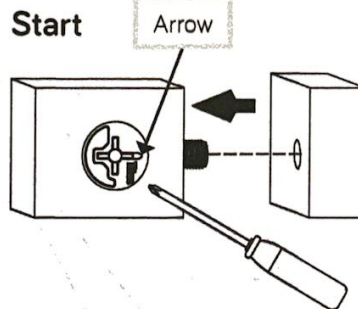

**Tighten**

Maximum 210 degrees

Minimum 190 degrees

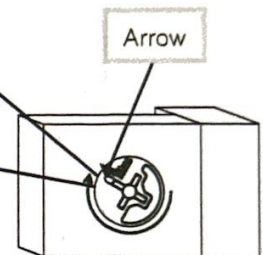

## Step 1

Look for this icon. It means a video assembly tip is available at [www.sauder.com/service/tips](http://www.sauder.com/service/tips). Find the numbered video or scan the QR code.



- Assemble your unit on a carpeted floor or on the empty carton to avoid scratching your unit or the floor.
- Push two HIDDEN CAMS (1F) into the LEFT END (B). Then, insert the metal end of a CAM DOWEL (2F) into each HIDDEN CAM.

Do not tighten the HIDDEN CAMS in this step.

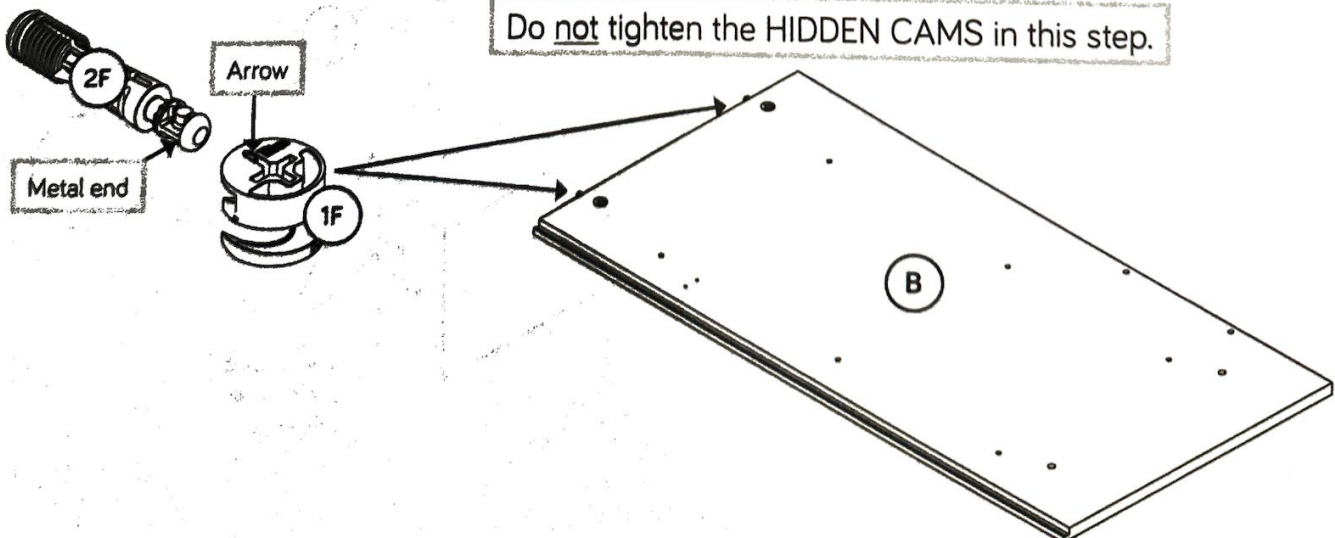

## Step 2

1



✚ Slide an END MOLDING\* (L) onto the notched edge of the LEFT END (B).

✚ Fasten a METAL BRACKET (1G) to the LEFT END (B). Use two BLACK 9/16" LARGE HEAD SCREWS (1S).

✚ \*U.S. Patent No. 5,499,886

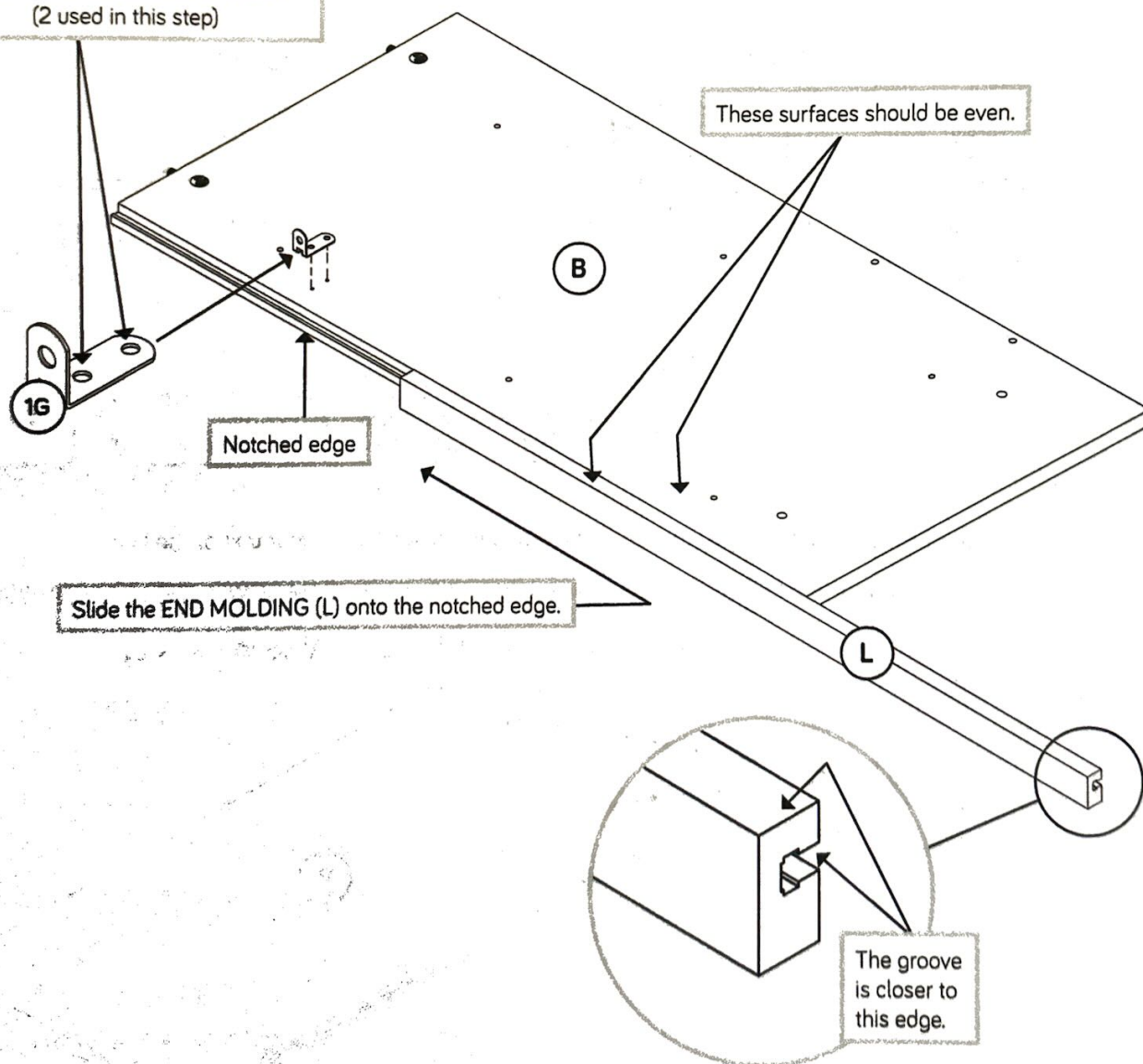
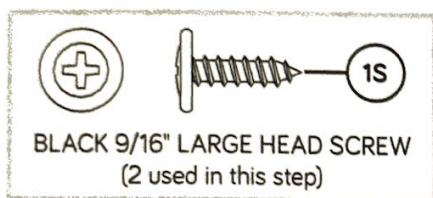



# Step 3

6



- Fasten three UNIVERSAL CABINET RAILS\* (35AA) to the LEFT END (B). Use six GOLD 5/16" FLAT HEAD SCREWS (3S) through holes #1 and #3.

\*patent pending glide system



Some assembly  
(and snacks) required.

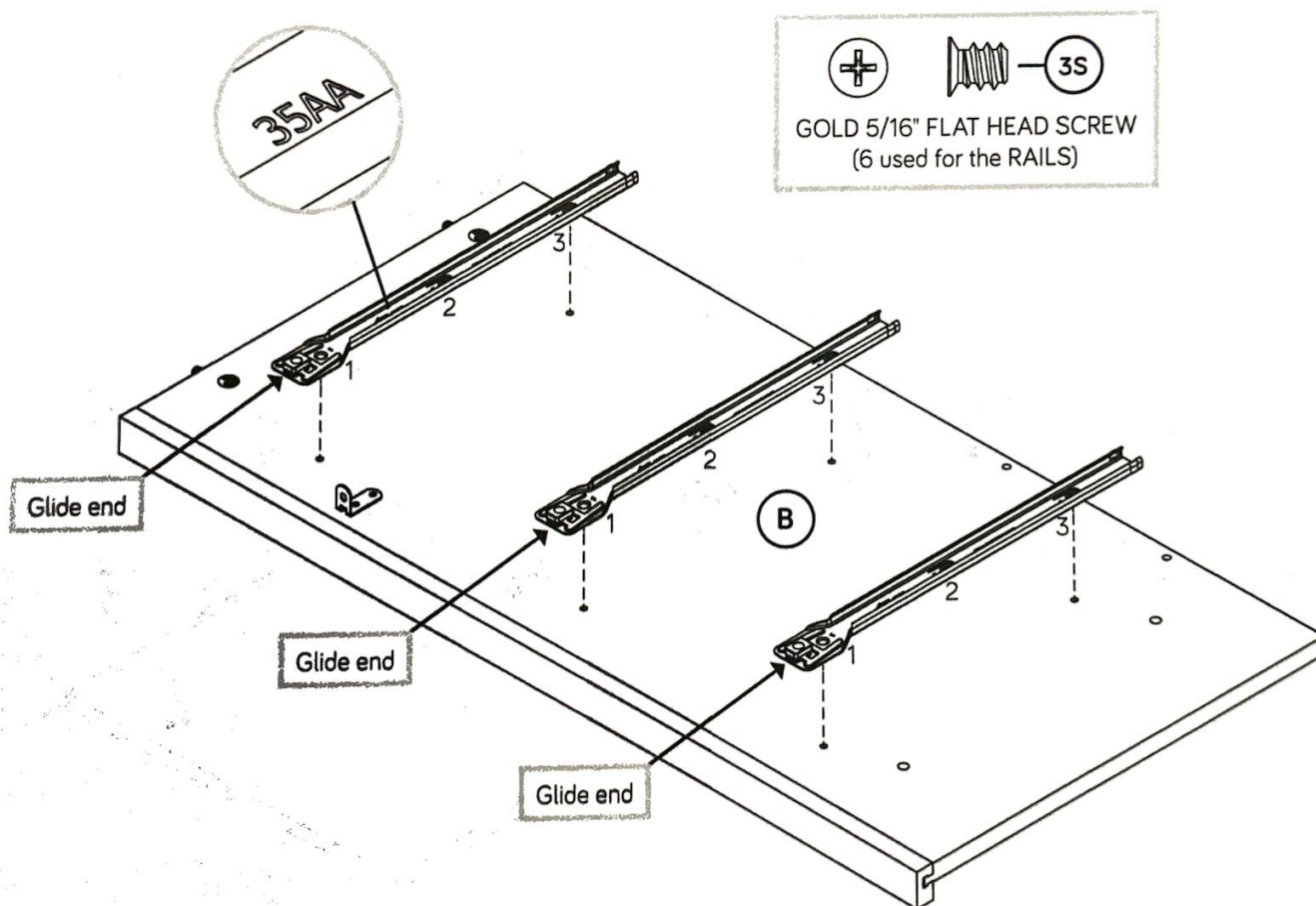

## Step 4

- ✚ Open the FURNITURE TIPPING RESTRAINT KIT (97), and fasten the SAFETY STRAP to the TOP (C). Use the provided SHORT SCREW.

✚ **NOTE:** Position the SAFETY STRAP exactly as shown.

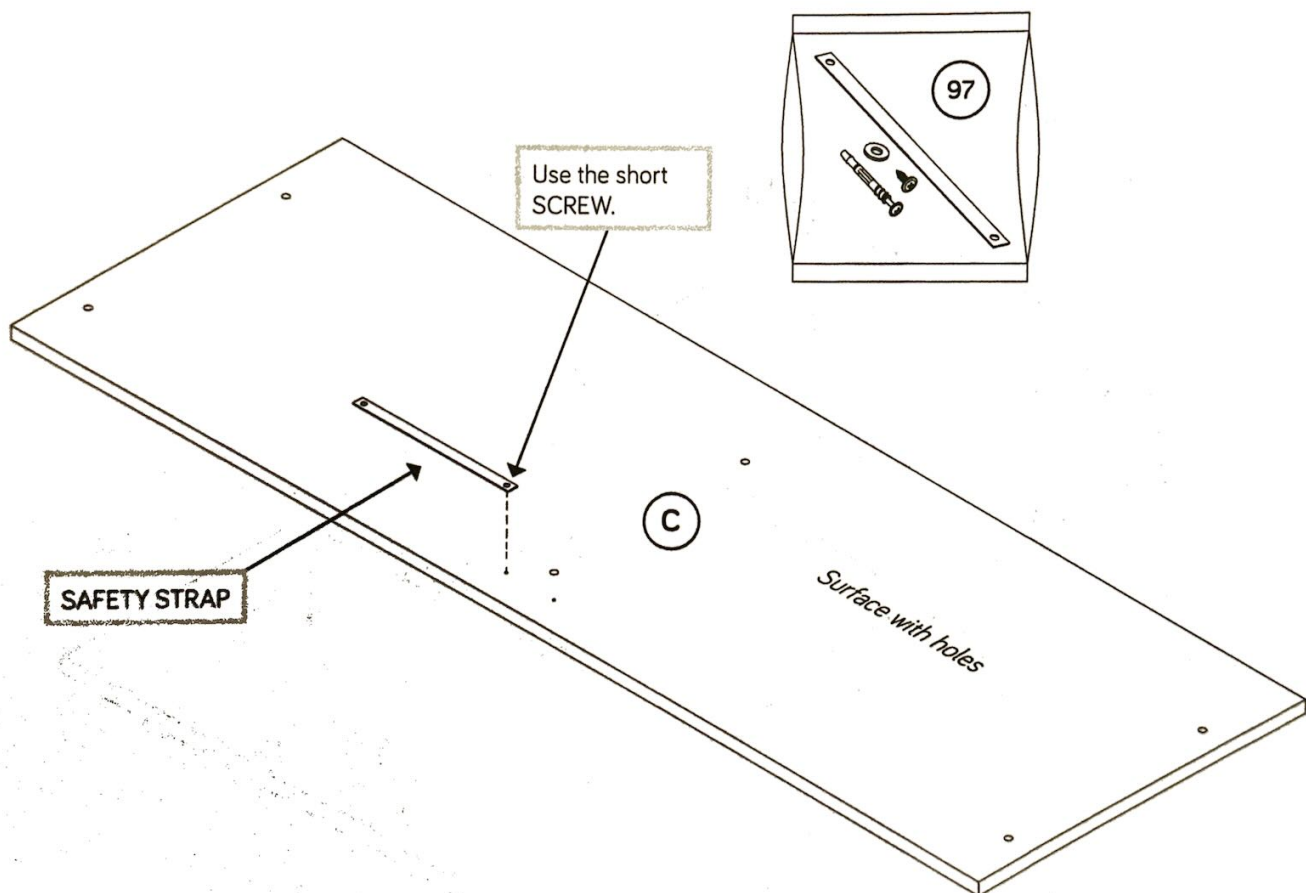



## Step 5



- ✚ Fasten the LEFT END (B) to the TOP (C).  
Tighten two HIDDEN CAMS.



### Caution

Do not stand the unit upright without the BACK fastened. The unit may collapse.

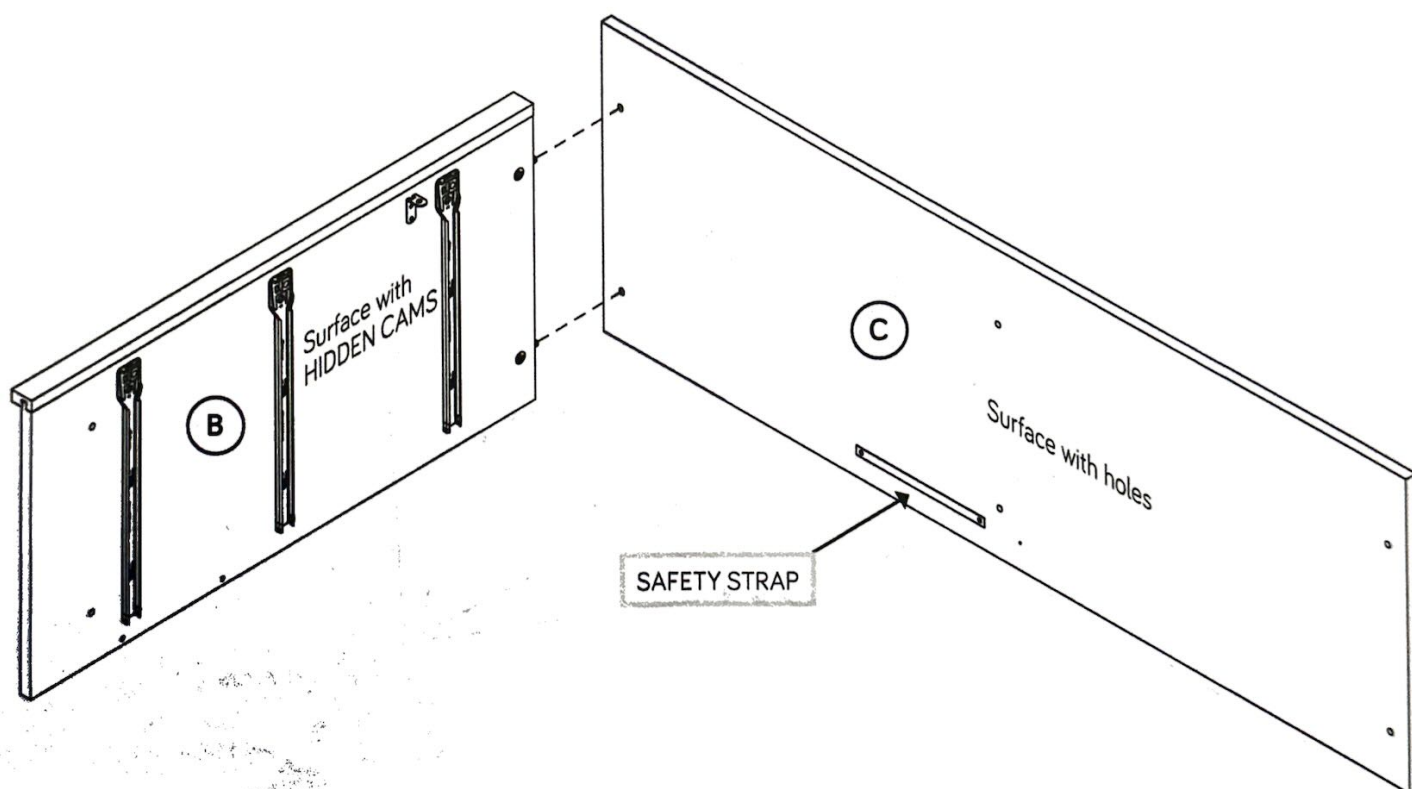

# Step 6

1



- 1 Push four HIDDEN CAMS (1F) into the BACKS (F). Then, insert the metal end of a CAM DOWEL (2F) into each HIDDEN CAM.

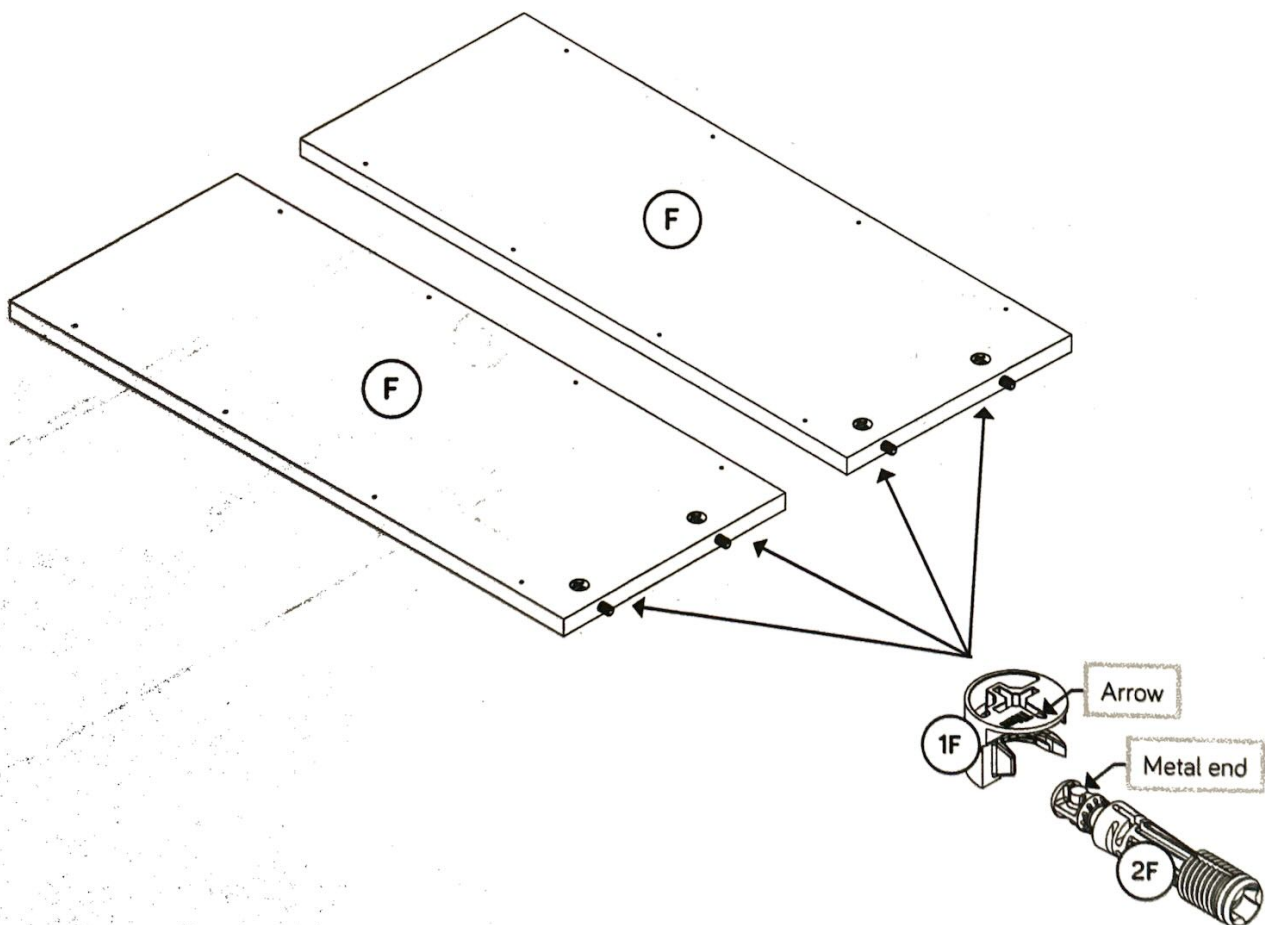



## Step 7

- ✚ Fasten a BACK (F) to the LEFT END (B). Use two BLACK 1-15/16" FLAT HEAD SCREWS (113S).

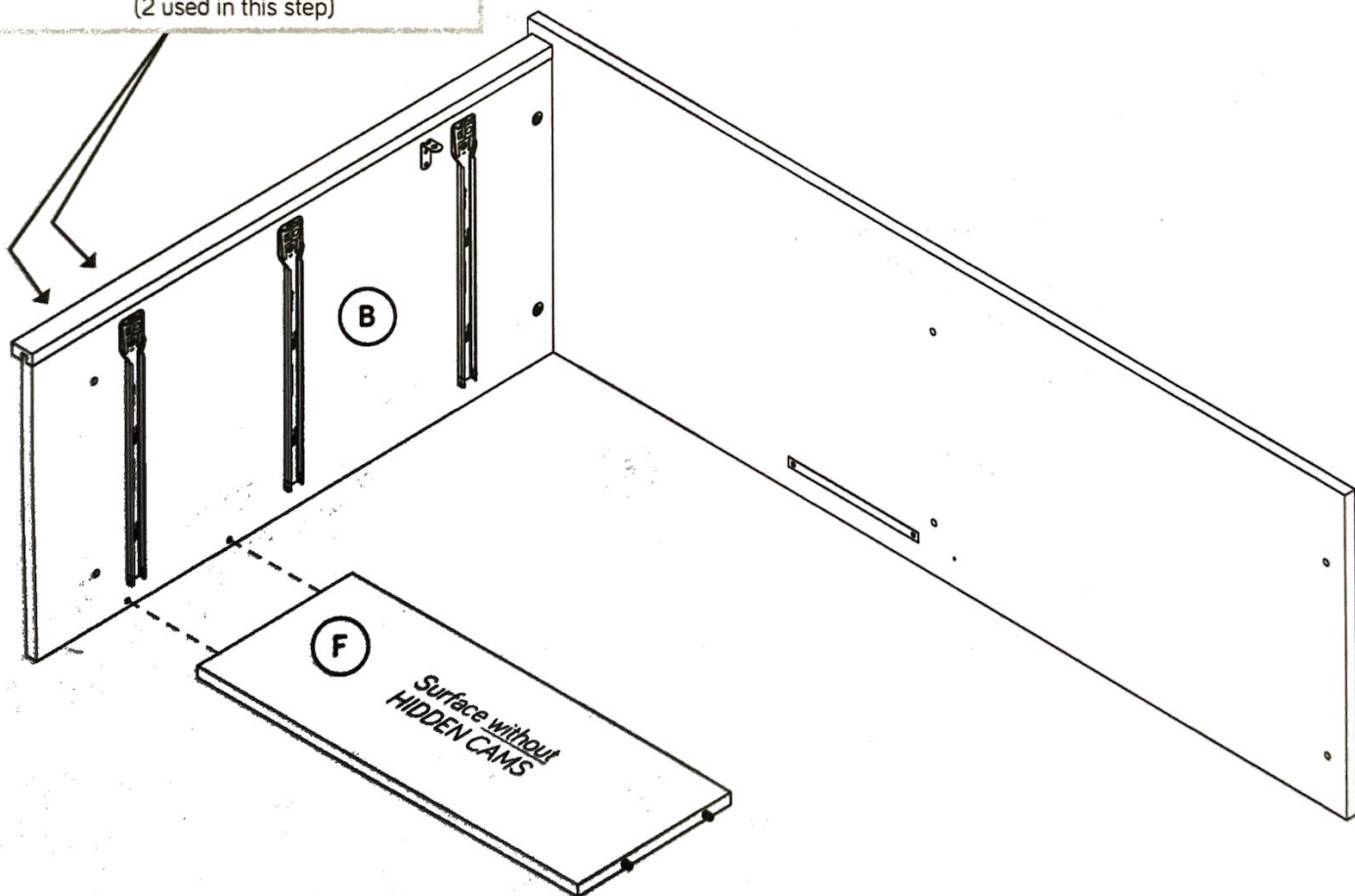
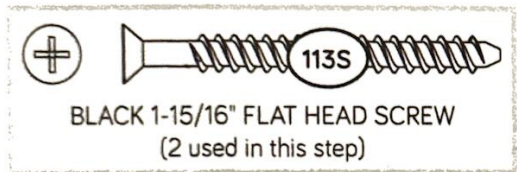

## Step 8

1



- Push two HIDDEN CAMS (1F) into the UPRIGHT (E). Then, insert the metal end of a CAM DOWEL (2F) into each HIDDEN CAM.
- Fasten a METAL BRACKET (1G) to the UPRIGHT (E). Use two BLACK 9/16" LARGE HEAD SCREWS (1S).

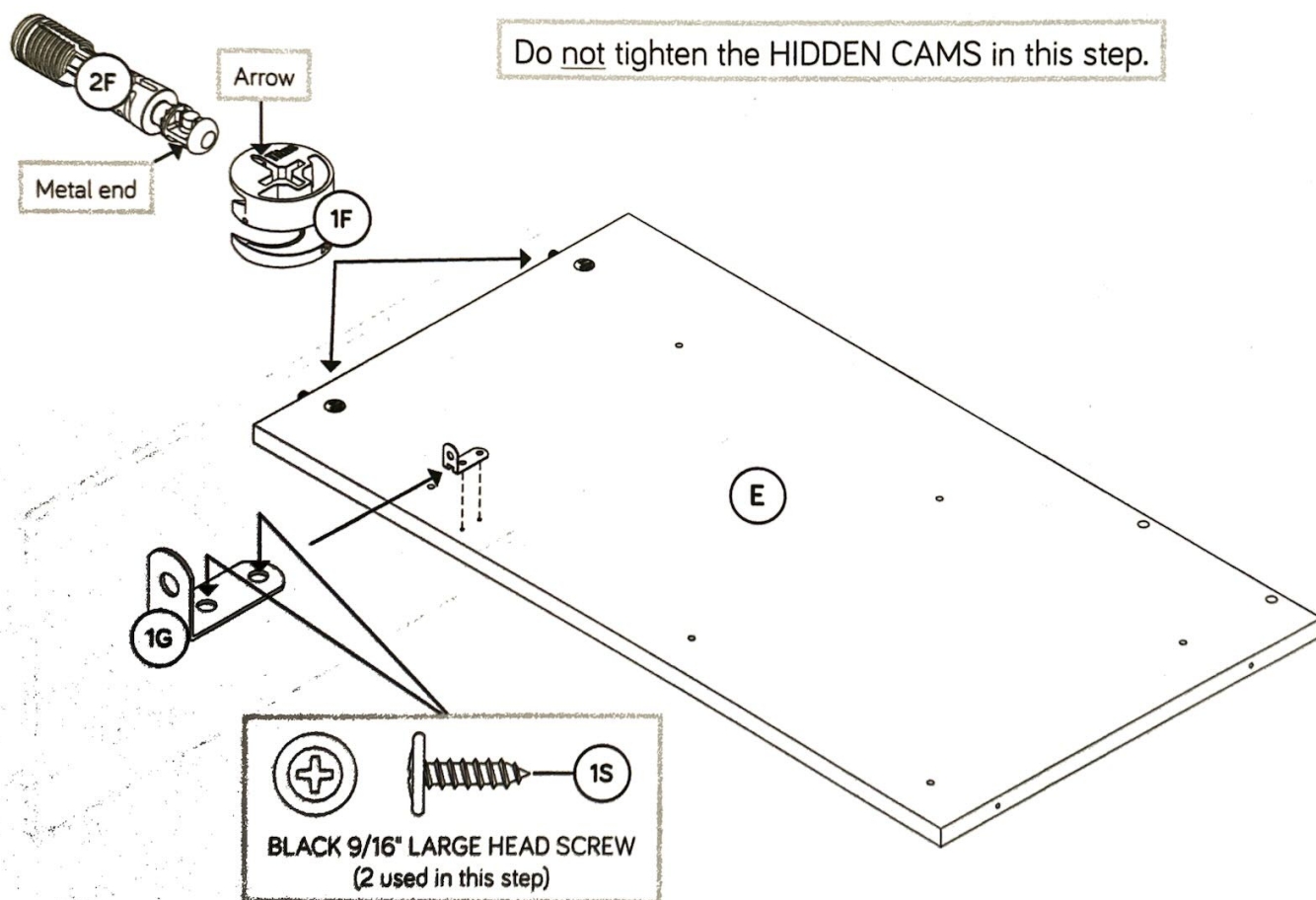



## Step 9

6



- Fasten six UNIVERSAL CABINET RAILS\* (35AA) to the UPRIGHT (E). Use twelve GOLD 5/16" FLAT HEAD SCREWS (3S) through holes #1 and #3.

\*patent pending glide system

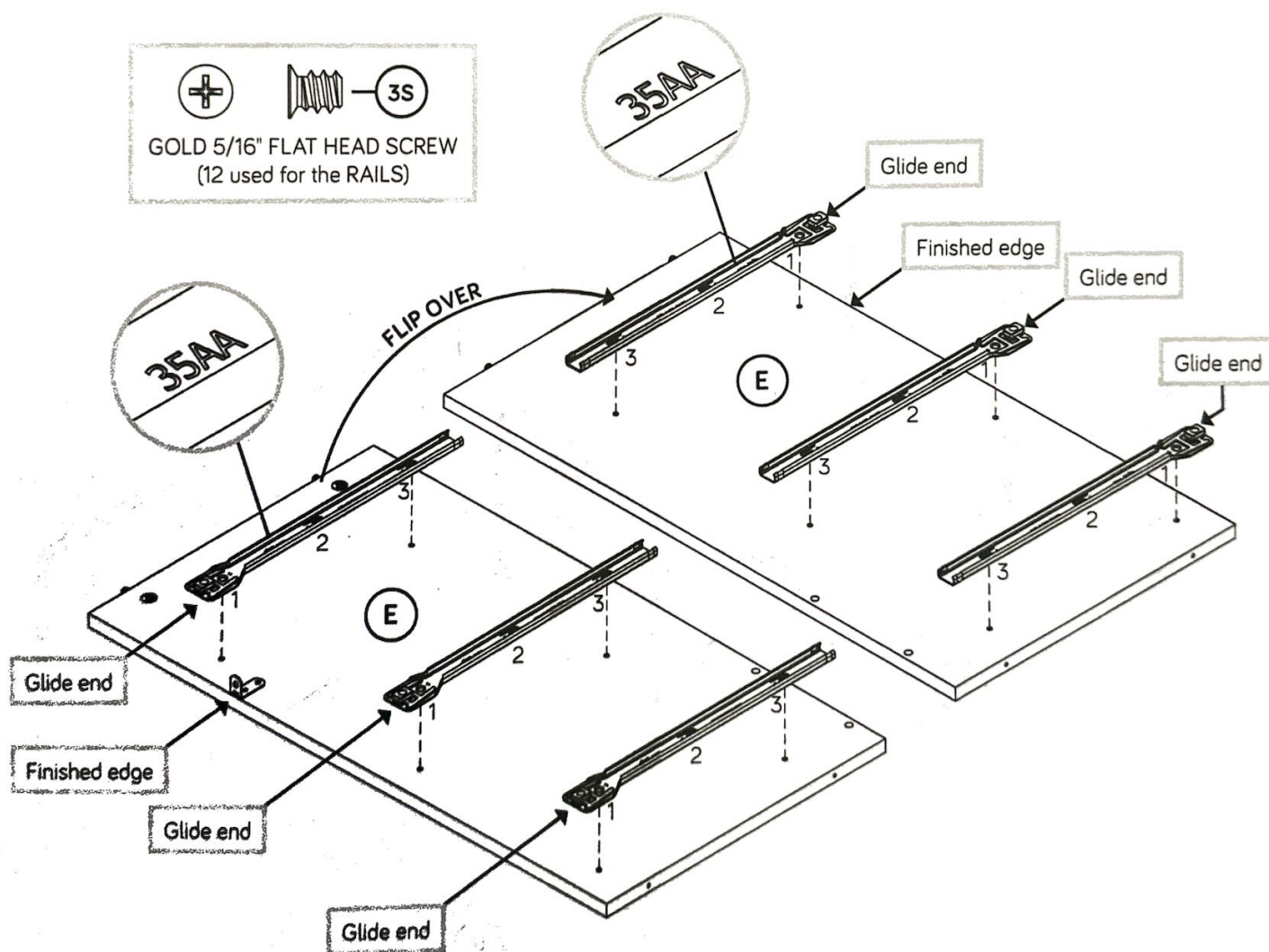

# Step 10

1



- ✚ Fasten the UPRIGHT (E) to the TOP (C). Tighten two HIDDEN CAMS.
- ✚ **NOTE:** Be sure the CAM DOWELS in the BACK (F) insert into the UPRIGHT (E).
- ✚ Push the CAM DOWELS in the remaining BACK (F) into the holes in the UPRIGHT (E).
- ✚ **NOTE:** The HIDDEN CAMS in the BACKS (F) will be tightened in step 18.

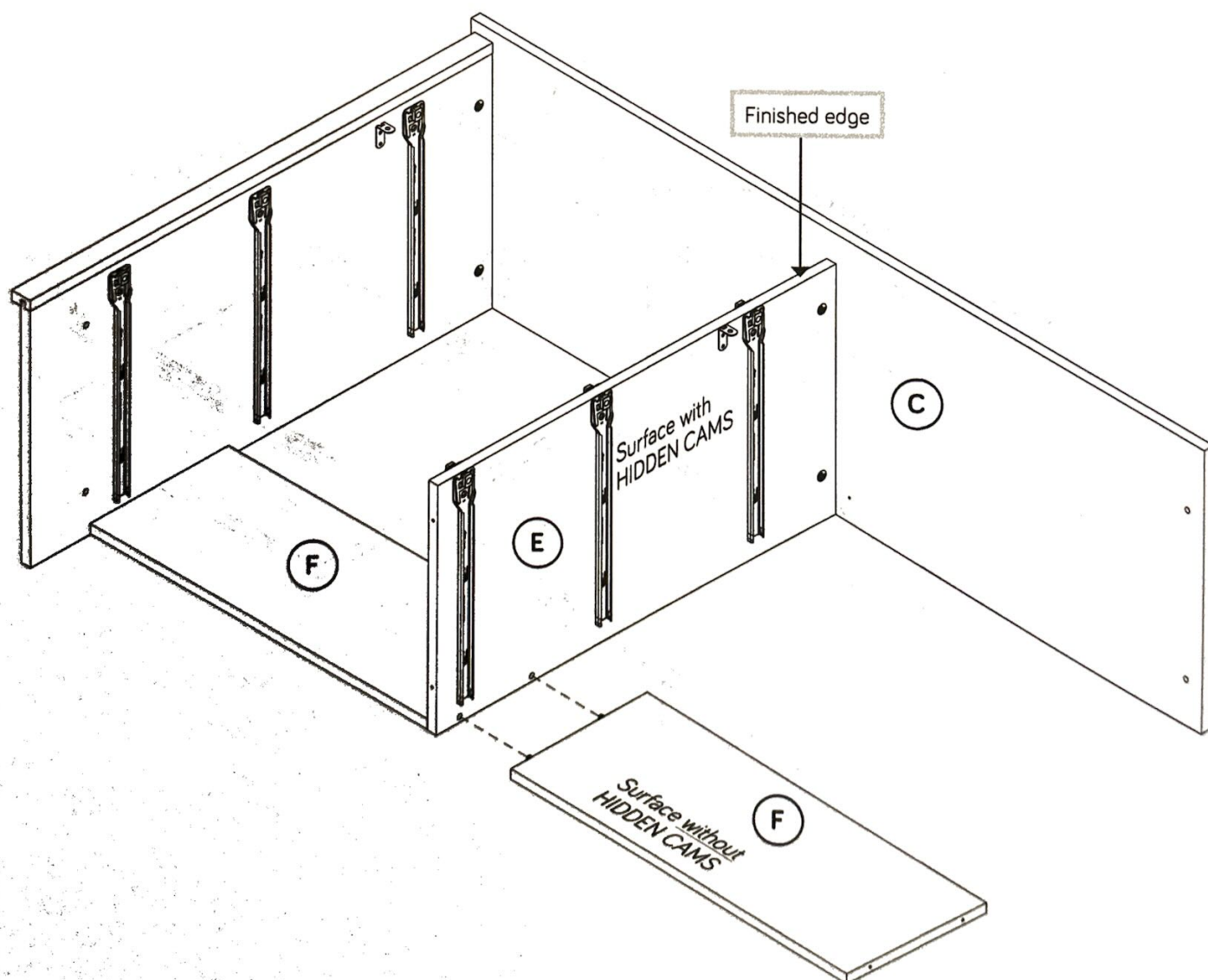



# Step 11

1



- ✚ Push four HIDDEN CAMS (1F) into the BOTTOM (D).  
Then, insert the metal end of a CAM DOWEL (2F) into each HIDDEN CAM.

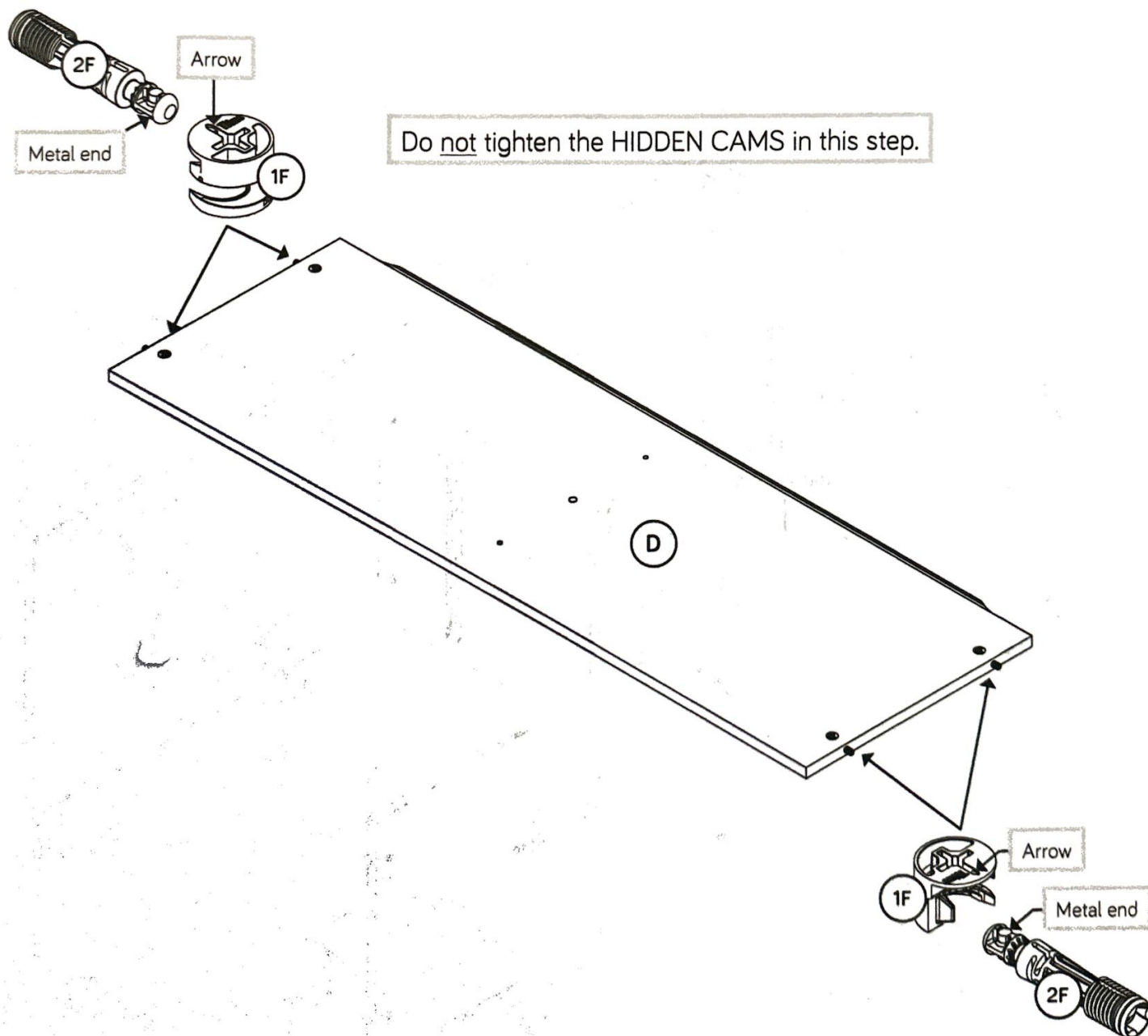

## Step 12

1



✚ Fasten the BOTTOM (D) to the LEFT END (B). Tighten two HIDDEN CAMS.

✚ Fasten the BOTTOM (D) to the UPRIGHT (E). Use two BLACK 1-15/16" FLAT HEAD SCREWS (113S).

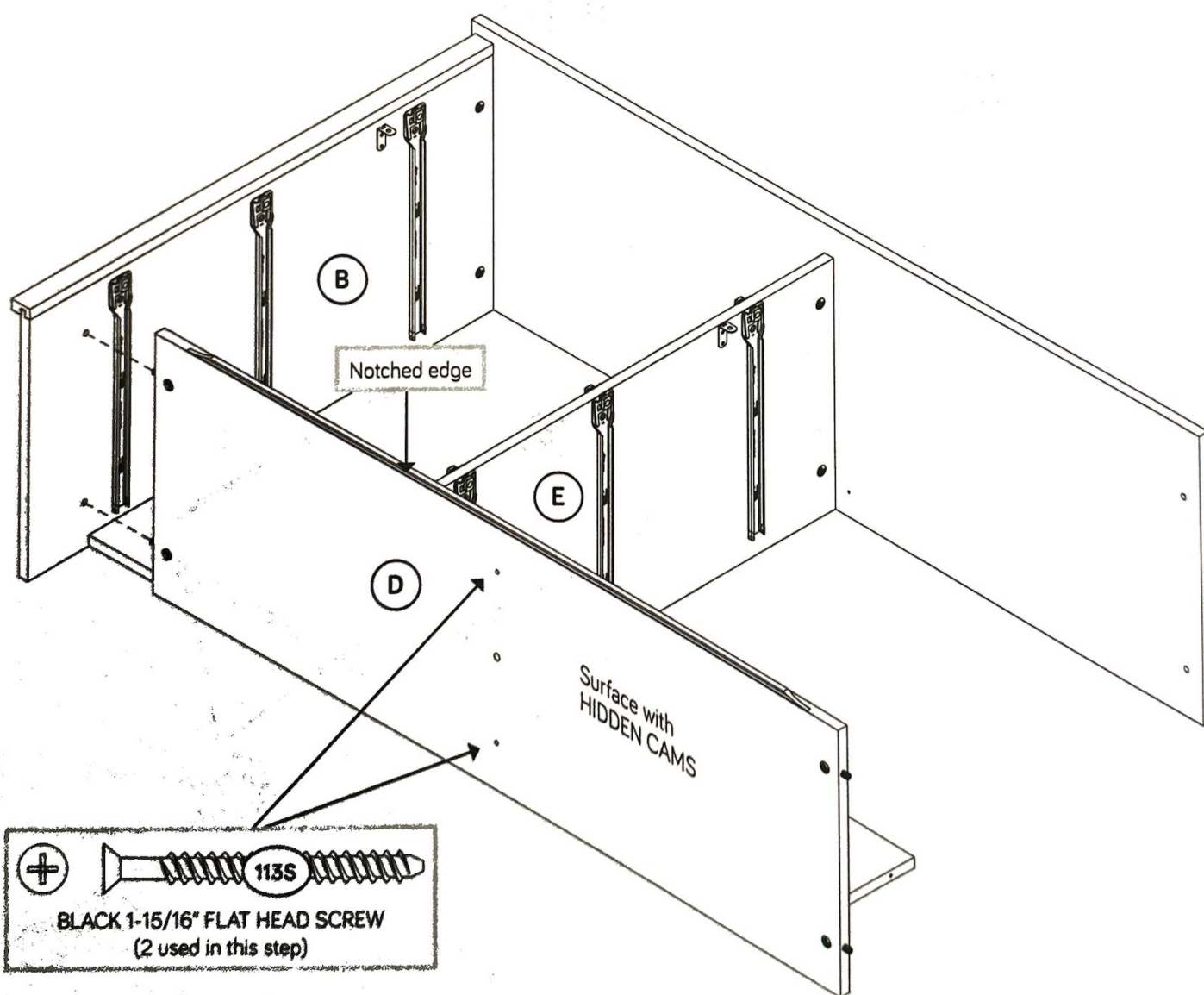



## Step 13

- Push the FOOT (3E) into the hole in the BOTTOM (D).
- Slide the SKIRT\* (M) completely onto the notched edge of the BOTTOM (D).

\*U.S. Patent No. 5,499,886

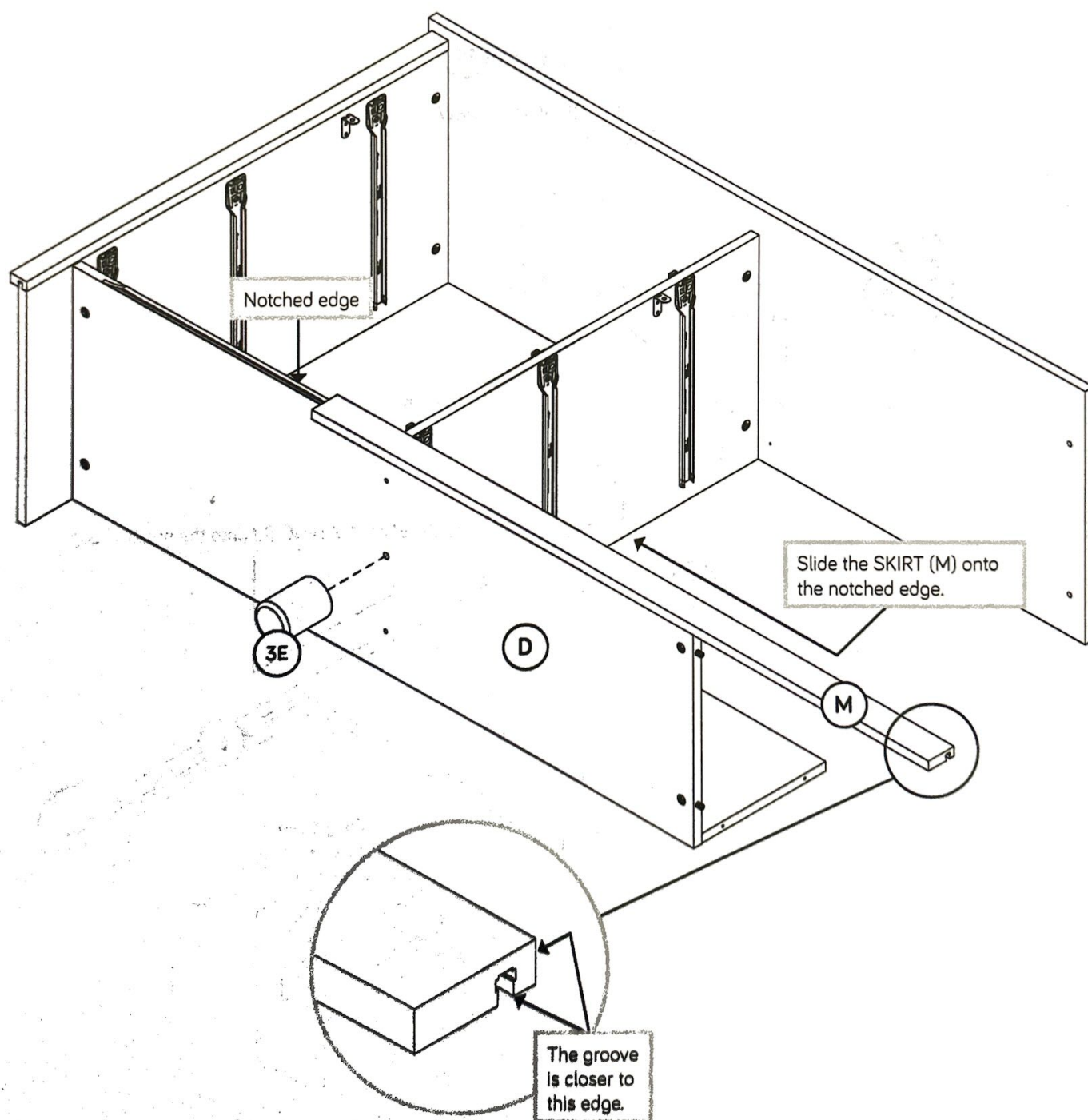

# Step 14

1



- ✚ Push two HIDDEN CAMS (1F) into the RIGHT END (A). Then, insert the metal end of a CAM DOWEL (2F) into each HIDDEN CAM.
- ✚ Slide the remaining END MOLDING\* (L) onto the notched edge of the RIGHT END (A).
- ✚ Fasten a METAL BRACKET (1G) to the RIGHT END (A). Use two BLACK 9/16" LARGE HEAD SCREWS (1S).
- ✚ \*U.S. Patent No. 5,499,886

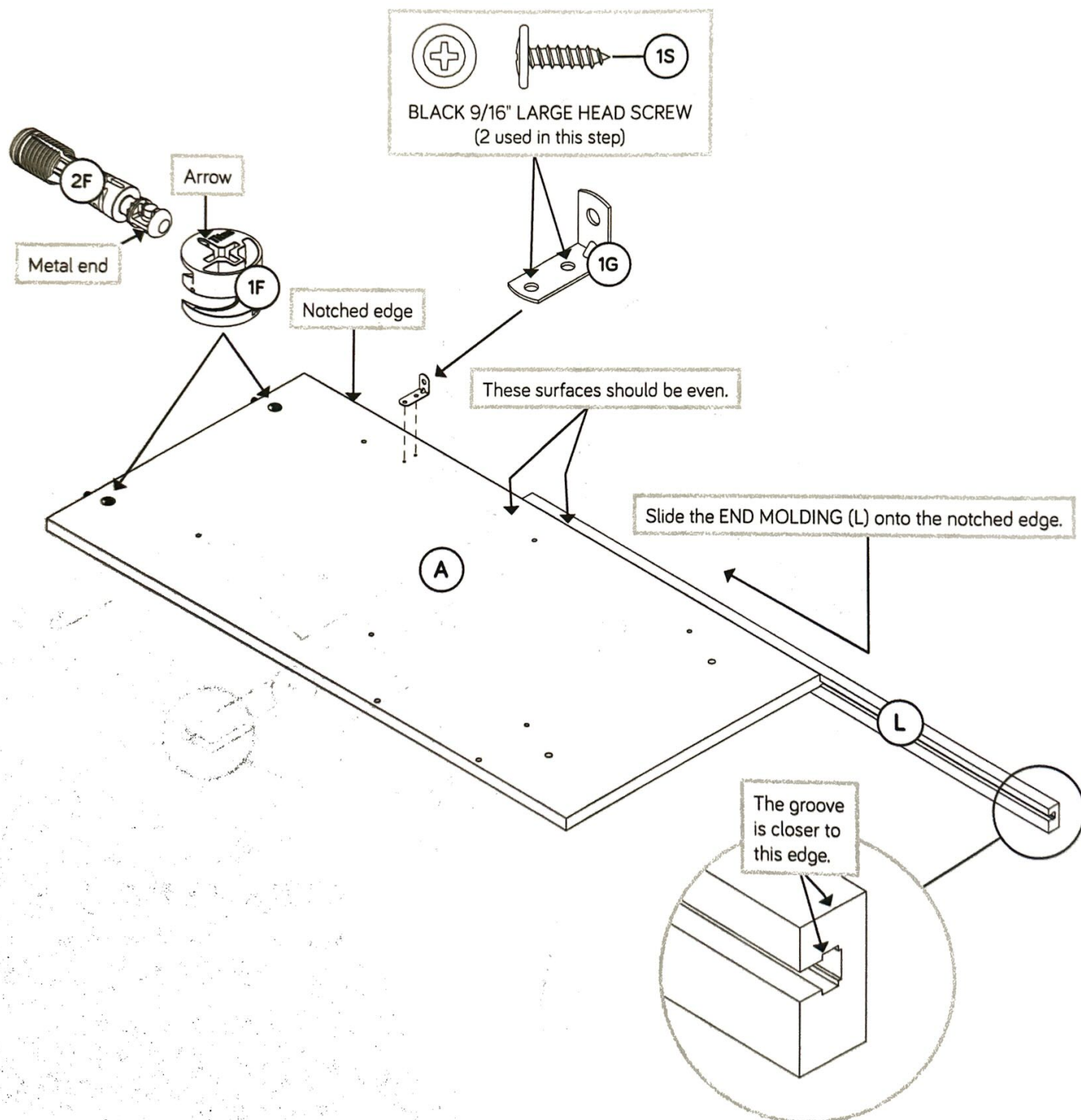

# Step 15

6



- Fasten the remaining UNIVERSAL CABINET RAILS\* (35AA) to the RIGHT END (A). Use six GOLD 5/16" FLAT HEAD SCREWS (3S) through holes #1 and #3.

\*patent pending glide system

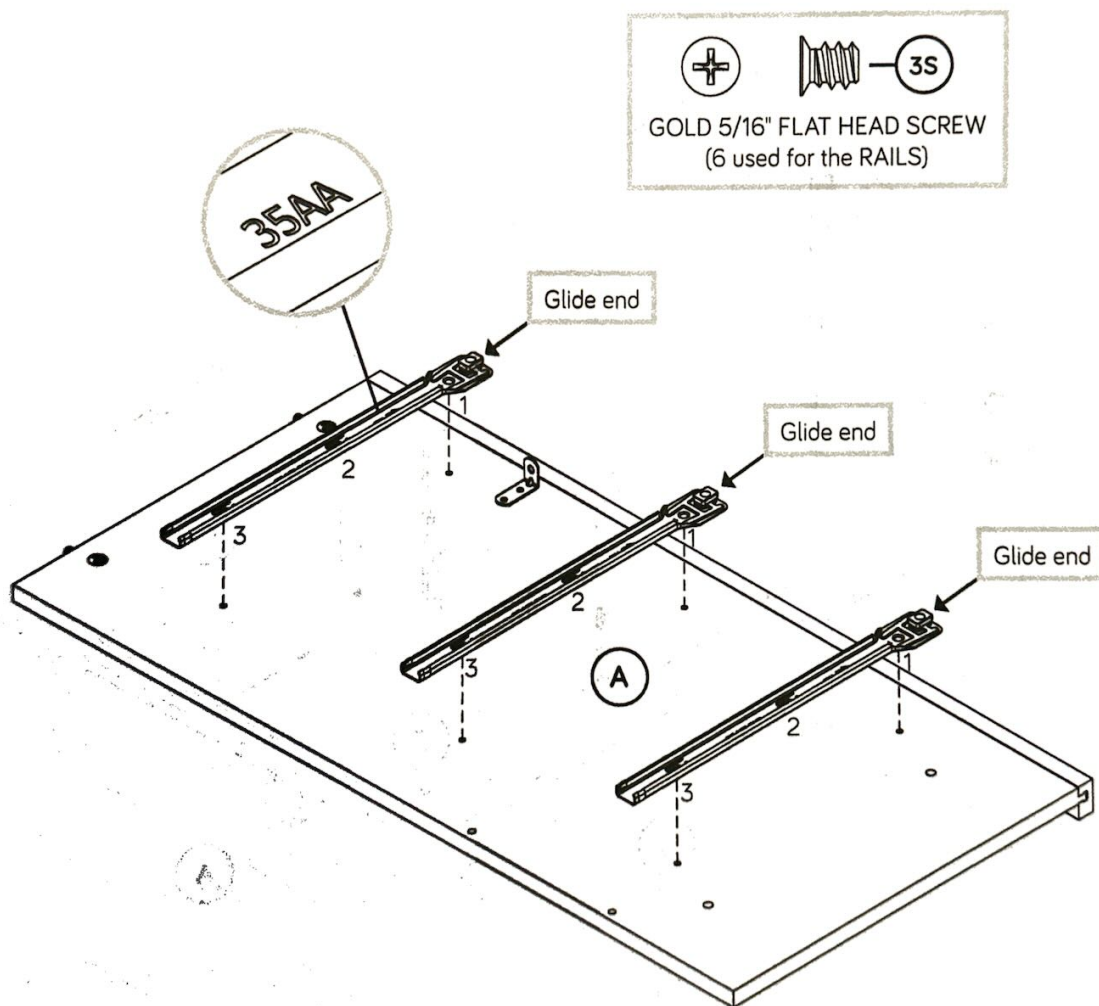



# Step 16

1



- Fasten the RIGHT END (A) to the TOP (C) and BOTTOM (D). Tighten four HIDDEN CAMS.
- Fasten the RIGHT END (A) to the BACK (F). Use two BLACK 1-15/16" FLAT HEAD SCREWS (113S).

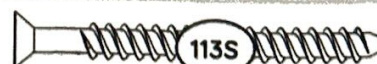
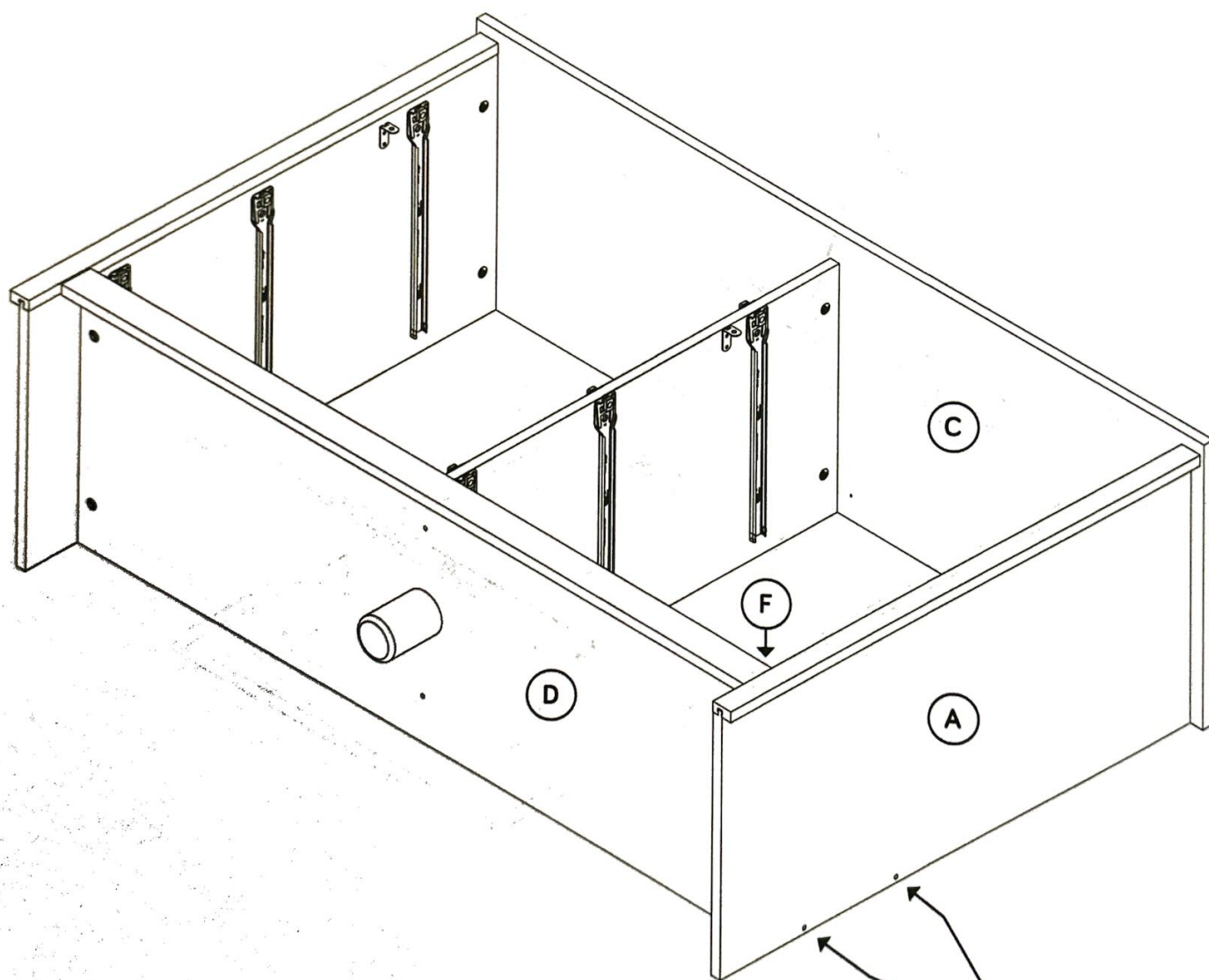

BLACK 1-15/16" FLAT HEAD SCREW  
(2 used in this step)

## Step 17

- ✦ Fasten the DUST RAIL (N) to the METAL BRACKETS on the ENDS (A and B) and UPRIGHT (E). Use three BLACK 9/16" LARGE HEAD SCREWS (1S).

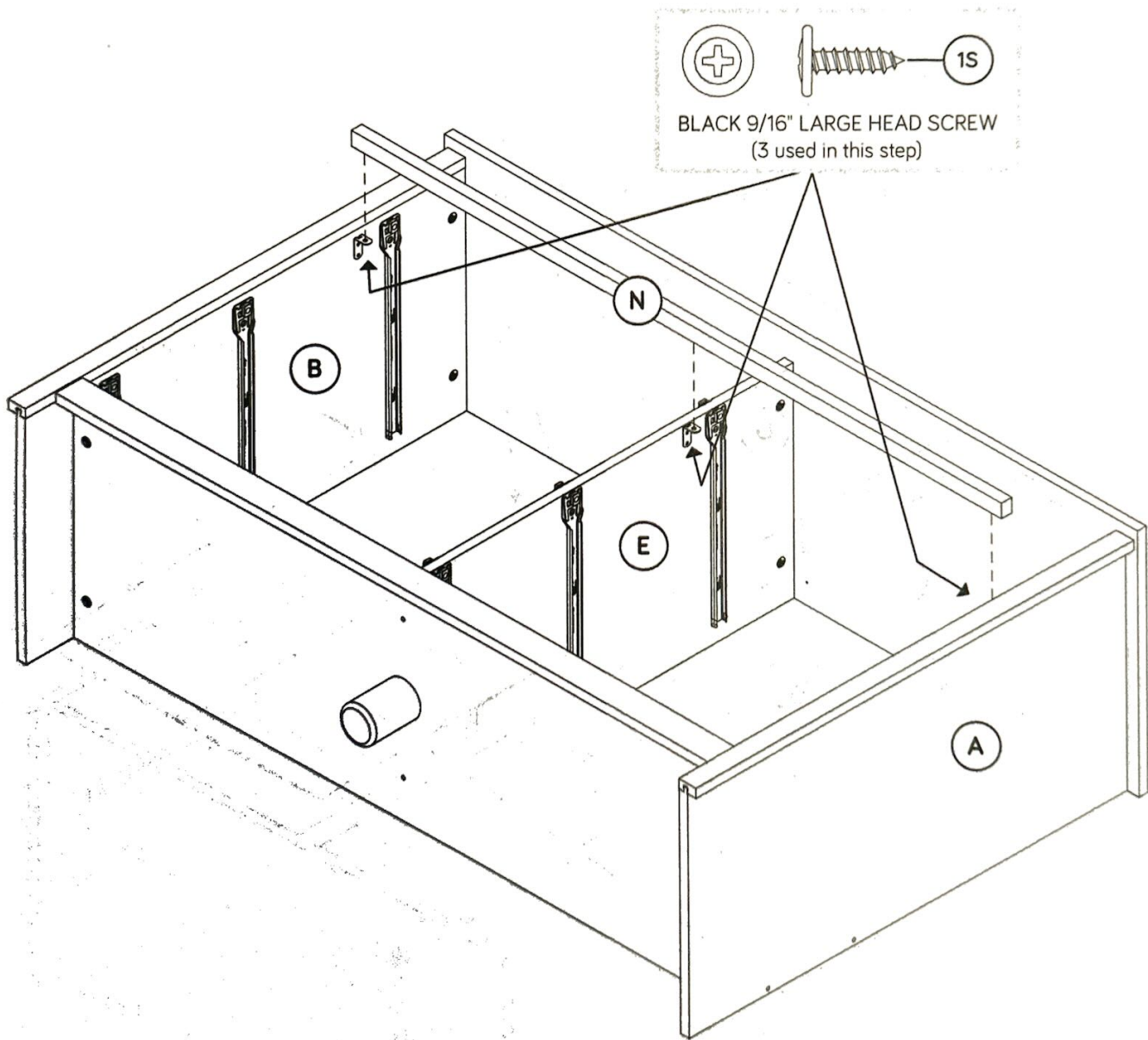

# Step 18

8



- ✚ Carefully turn your unit over onto its front edges. Tighten the HIDDEN CAMS in the BACKS (F).
- ✚ Unfold the LARGE BACK (O) and lay it over your unit. Push the SAFETY STRAP through the large hole in the LARGE BACK (O).
- ✚ Turn eight BLACK 9/16" LARGE HEAD SCREWS (1S) into the bottom edge of the LARGE BACK (O) and into the BACKS (F). Do not completely tighten the SCREWS at this time.
- ✚ Then, making sure that the top edge of the LARGE BACK (O) sits slightly below the top edge of your unit, fasten the top and side edges of the LARGE BACK to your unit using the NAILS (1N).
- ✚ Now, completely tighten the SCREWS in the bottom edge of the LARGE BACK (O).
- ✚ **NOTE:** Be sure to tap NAILS into the holes that line up over the UPRIGHT (E).

## Caution

Do not stand the unit upright without the BACK fastened. The unit may collapse.

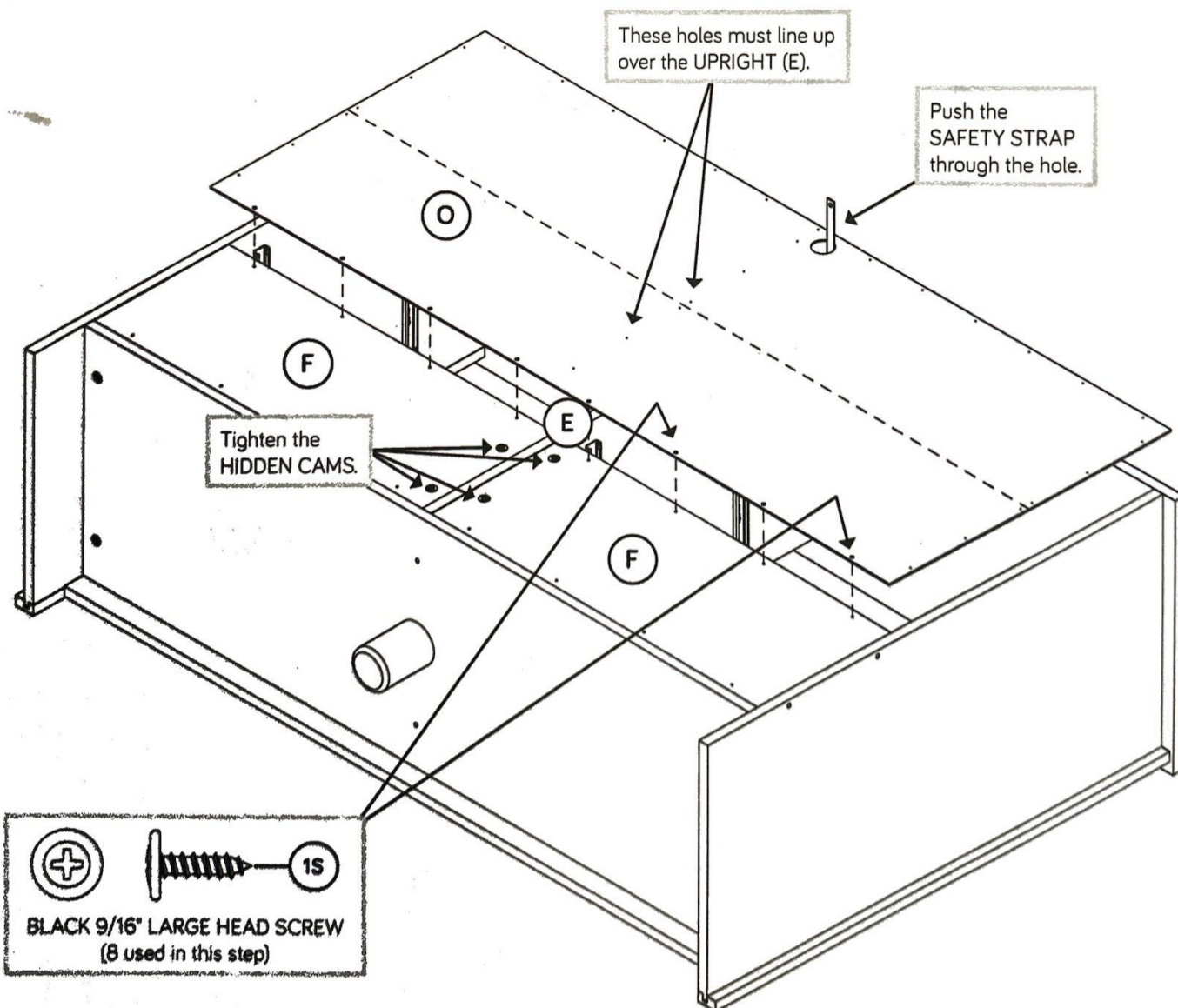



## Step 19

⚠ Carefully stand your unit upright in its final location against a wall. We recommend using the SAFETY STRAP for added stability.

⚠ **NOTE:** Do not turn the SAFETY DRYWALL ANCHOR into a wall stud. If you prefer to fasten the SAFETY STRAP to a wall stud, go to your local hardware store for proper hardware.

### ⚠ INSTALLATION INSTRUCTIONS:

1. Insert the SAFETY DRYWALL ANCHOR through the WASHER and the end of the SAFETY STRAP.
2. Using a Phillips screwdriver or a hand drill, press the screw slightly onto the drywall just below the top surface of your unit so the SAFETY STRAP will not be visible.
3. Apply pressure; turn the screw until a pilot hole is made and the nylon sheath slips through.
4. Turn the screw until it is flush against the wall and you feel a firm resistance.
5. Continue to turn until the screw starts spinning freely.

⚠ **NOTE:** Before moving your unit to a different location, unscrew the SAFETY DRYWALL ANCHOR from your wall. The nylon sheath will remain behind your wall.

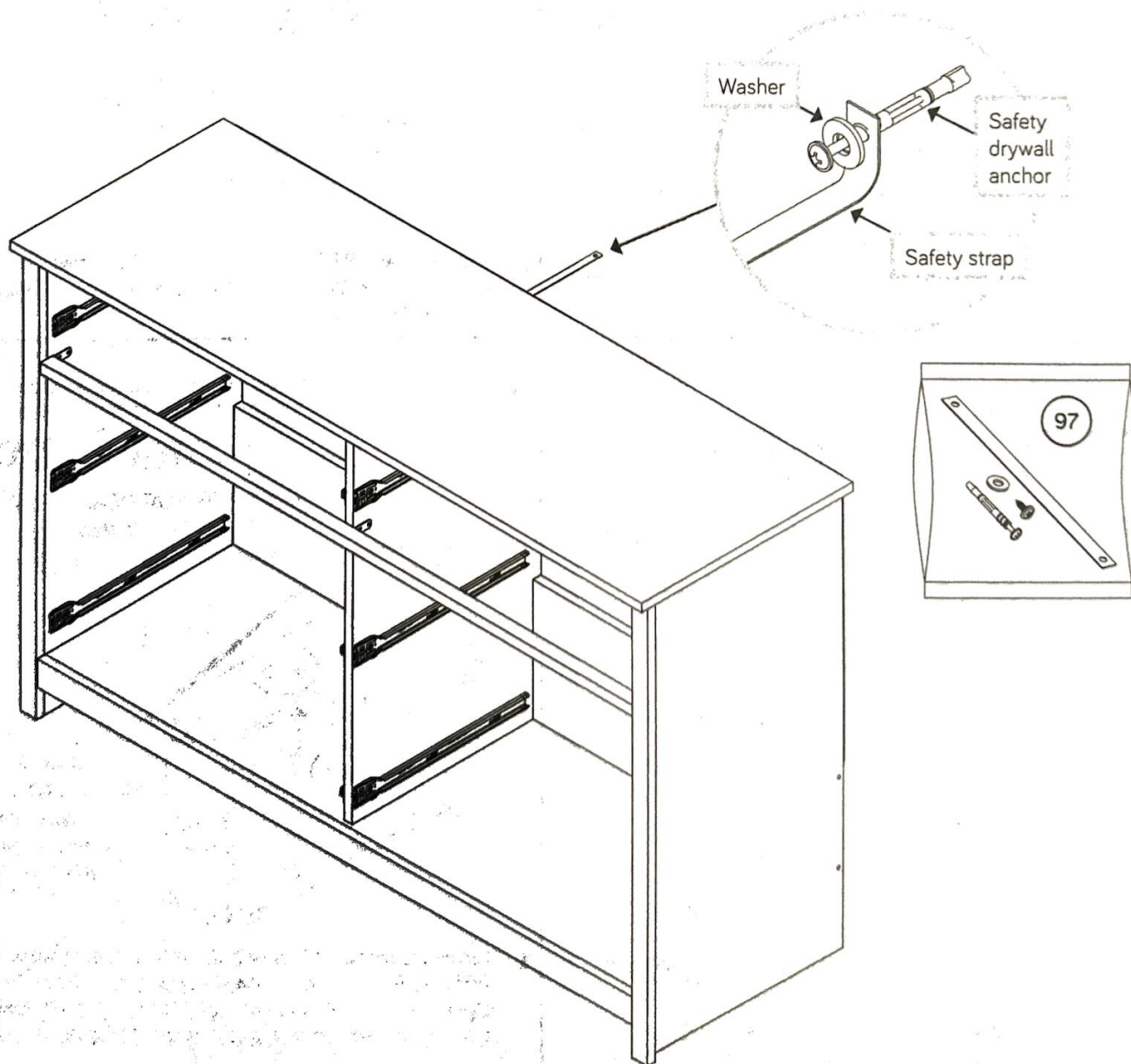

# Step 20

11



1

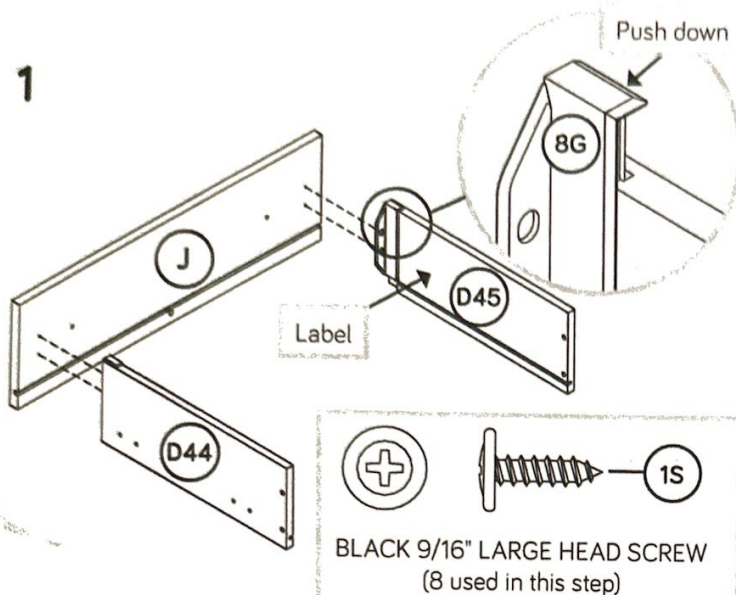

- ✦ Pull the SMALL DRAWER FRONT BRACKETS (8G) apart and slide them into the grooves in the SMALL DRAWER SIDES (D44 and D45 with label). You may need to gently tap them in with a hammer.
- ✦ **NOTE:** The DRAWER FRONT BRACKETS are marked "RH" and "LH" for easy identification.
- ✦ Fasten the SMALL LEFT DRAWER FRONT (J) to the SMALL DRAWER FRONT BRACKETS (8G). Use four BLACK 9/16" LARGE HEAD SCREWS (1S).

2

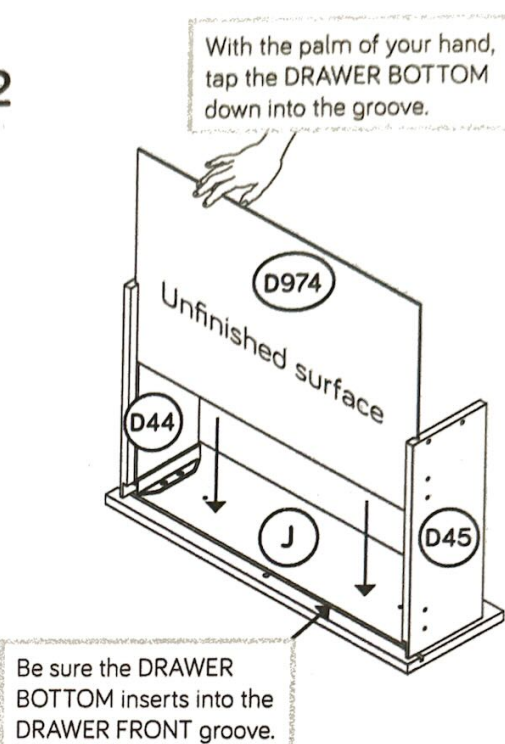

- ✦ Slide a DRAWER BOTTOM (D974) into the grooves in the SMALL DRAWER SIDES (D44 and D45) and SMALL LEFT DRAWER FRONT (J).

3

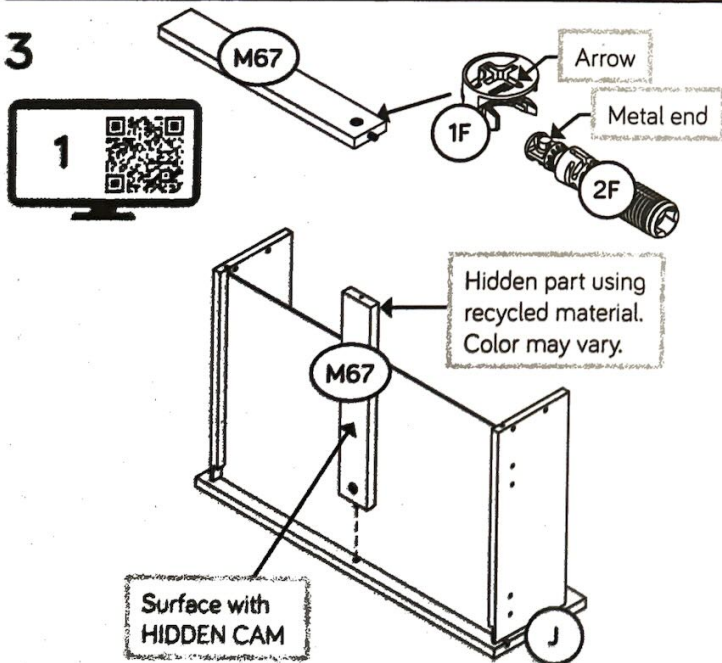

- ✦ Push a HIDDEN CAM (1F) into a DRAWER BRACE (M67). Then, insert the metal end of a CAM DOWEL (2F) into the HIDDEN CAM.
- ✦ Fasten the DRAWER BRACE (M67) to the SMALL LEFT DRAWER FRONT (J). Tighten one HIDDEN CAM.

4

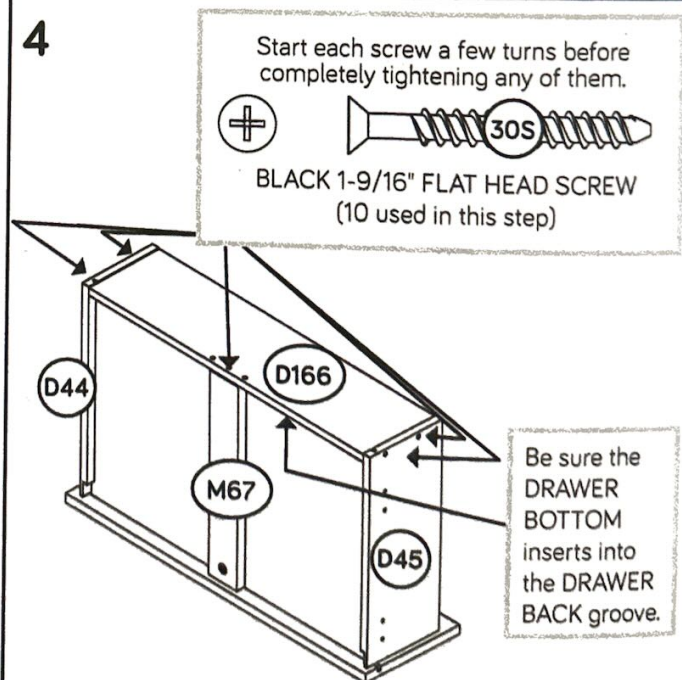

- ✦ Fasten the SMALL DRAWER BACK (D166) to the SMALL DRAWER SIDES (D44 and D45) and DRAWER BRACE (M67). Use five BLACK 1-9/16" FLAT HEAD SCREWS (30S). Repeat this step using the SMALL RIGHT DRAWER FRONT (K).



# Step 21

6



- Fasten the DRAWER RIGHT (35AC) to the SMALL RIGHT DRAWER SIDE (D44) and the DRAWER LEFT (35AD) to the SMALL LEFT DRAWER SIDE (D45). Use four GOLD 5/16" FLAT HEAD SCREWS (3S) through holes #1 and #2.

**NOTE:** The glides are not intended to rotate.

- Fasten two KNOBS (199K) to the SMALL LEFT DRAWER FRONT (J). Use two BLACK 7/8" MACHINE SCREWS (37S).

- Repeat this step for the remaining SMALL DRAWER.

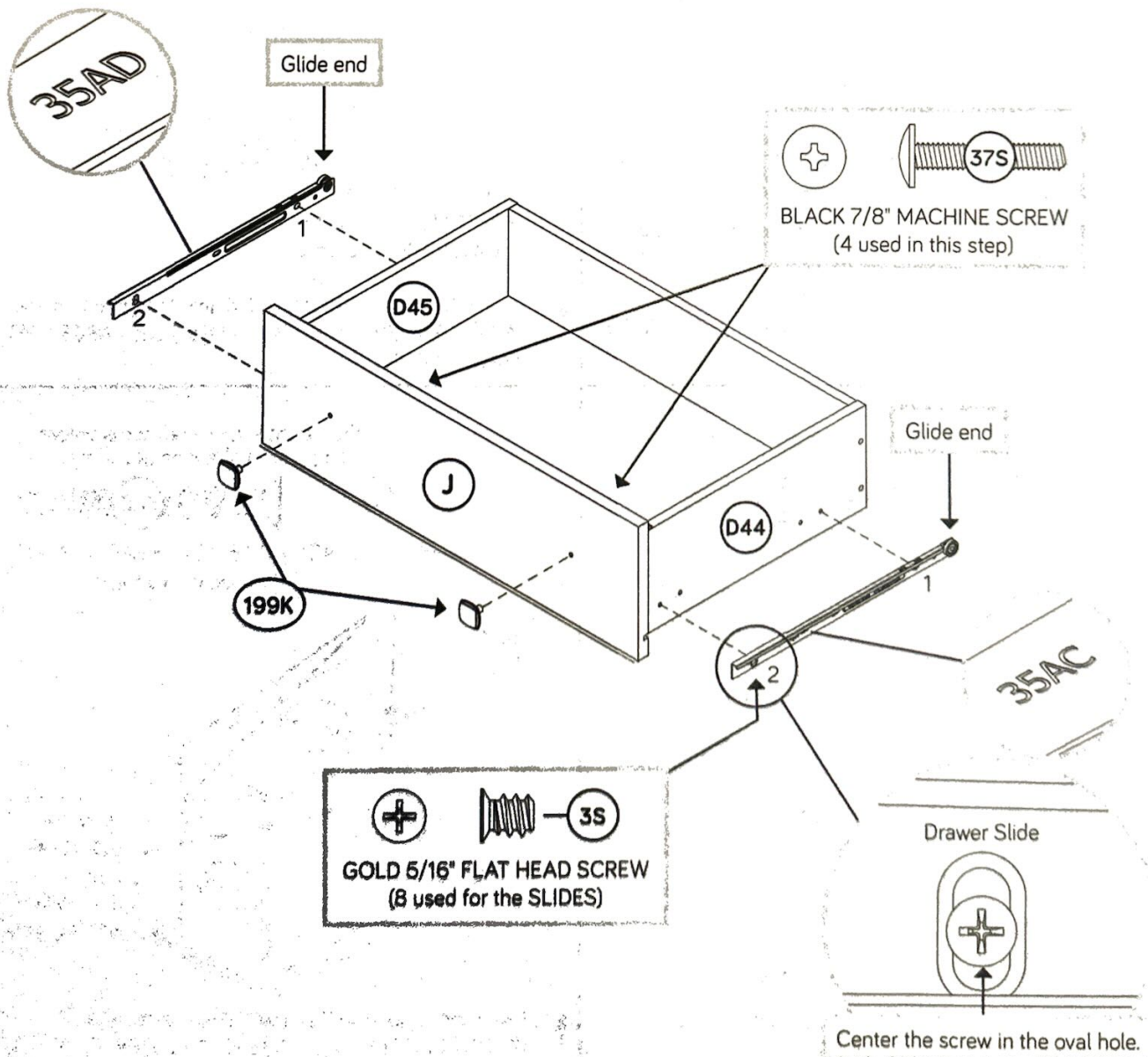



# Step 22

11

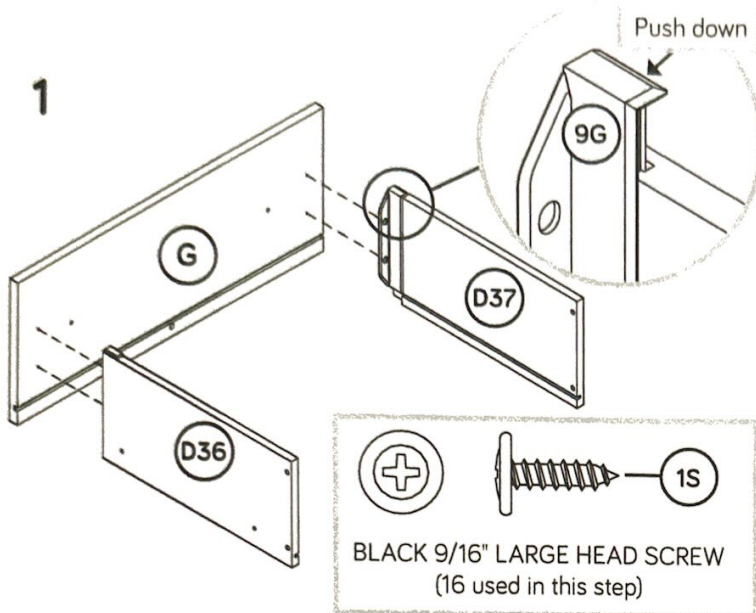

- 1 Pull the LARGE DRAWER FRONT BRACKETS (9G) apart and slide them into the grooves in the LARGE DRAWER SIDES (D36 and D37). You may need to gently tap them in with a hammer.
- 2 **NOTE:** The DRAWER FRONT BRACKETS are marked "RH" and "LH" for easy identification.
- 3 Fasten the LARGE LEFT DRAWER FRONT (G) to the LARGE DRAWER FRONT BRACKETS (9G). Use four BLACK 9/16" LARGE HEAD SCREWS (1S).

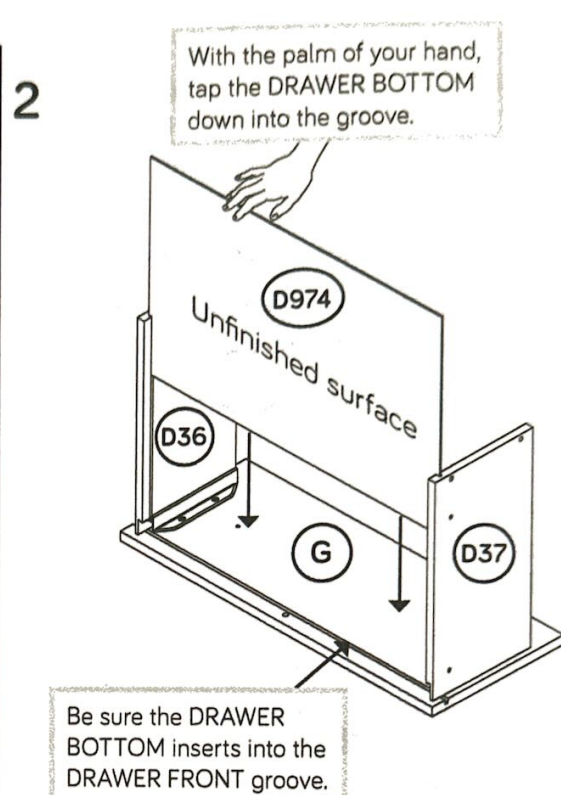

- 1 Slide a DRAWER BOTTOM (D974) into the grooves in the LARGE DRAWER SIDES (D36 and D37) and LARGE LEFT DRAWER FRONT (G).

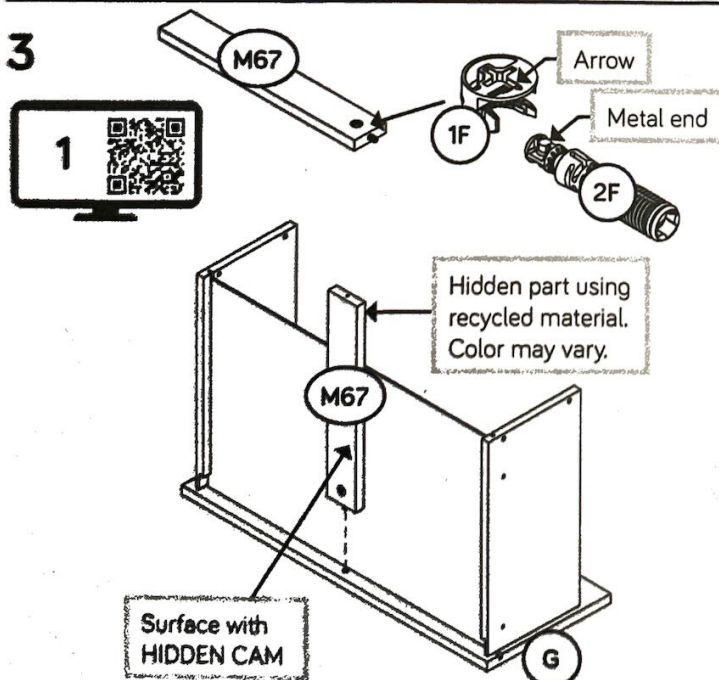

- 1 Push a HIDDEN CAM (1F) into a DRAWER BRACE (M67). Then, insert the metal end of a CAM DOWEL (2F) into the HIDDEN CAM.
- 2 Fasten the DRAWER BRACE (M67) to the LARGE LEFT DRAWER FRONT (G). Tighten one HIDDEN CAM.

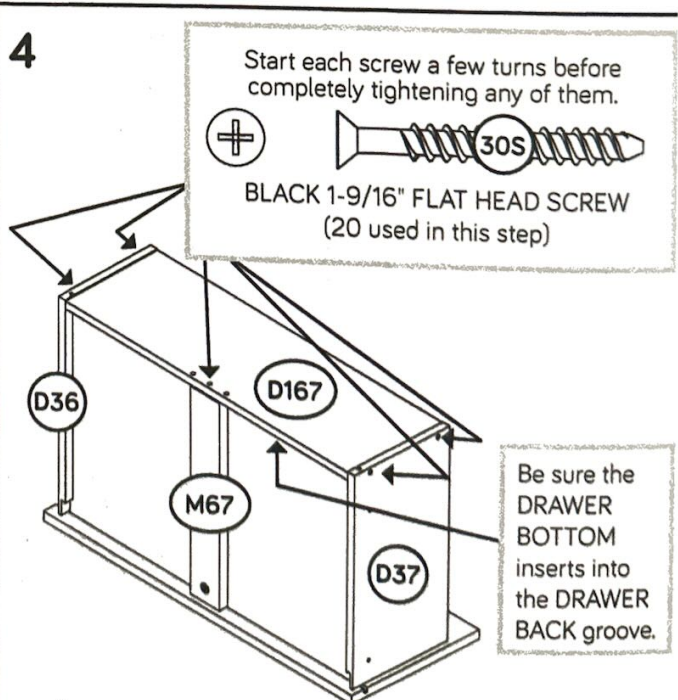

- 1 Fasten the LARGE DRAWER BACK (D167) to the LARGE DRAWER SIDES (D36 and D37) and DRAWER BRACE (M67). Use five BLACK 1-9/16" FLAT HEAD SCREWS (30S). Repeat this step using the remaining LARGE DRAWER FRONTS (G and H).

# Step 23

6



- Fasten the DRAWER RIGHT (35AC) to the LARGE RIGHT DRAWER SIDE (D36) and the DRAWER LEFT (35AD) to the LARGE LEFT DRAWER SIDE (D37). Use four GOLD 5/16" FLAT HEAD SCREWS (3S) through holes #1 and #2.

**NOTE:** The glides are not intended to rotate.

- Fasten two KNOBS (199K) to the LARGE LEFT DRAWER FRONT (G). Use two BLACK 7/8" MACHINE SCREWS (37S).

- Repeat this step for the remaining LARGE DRAWERS.

Zzz

Almost time to celebrate! With a nap.

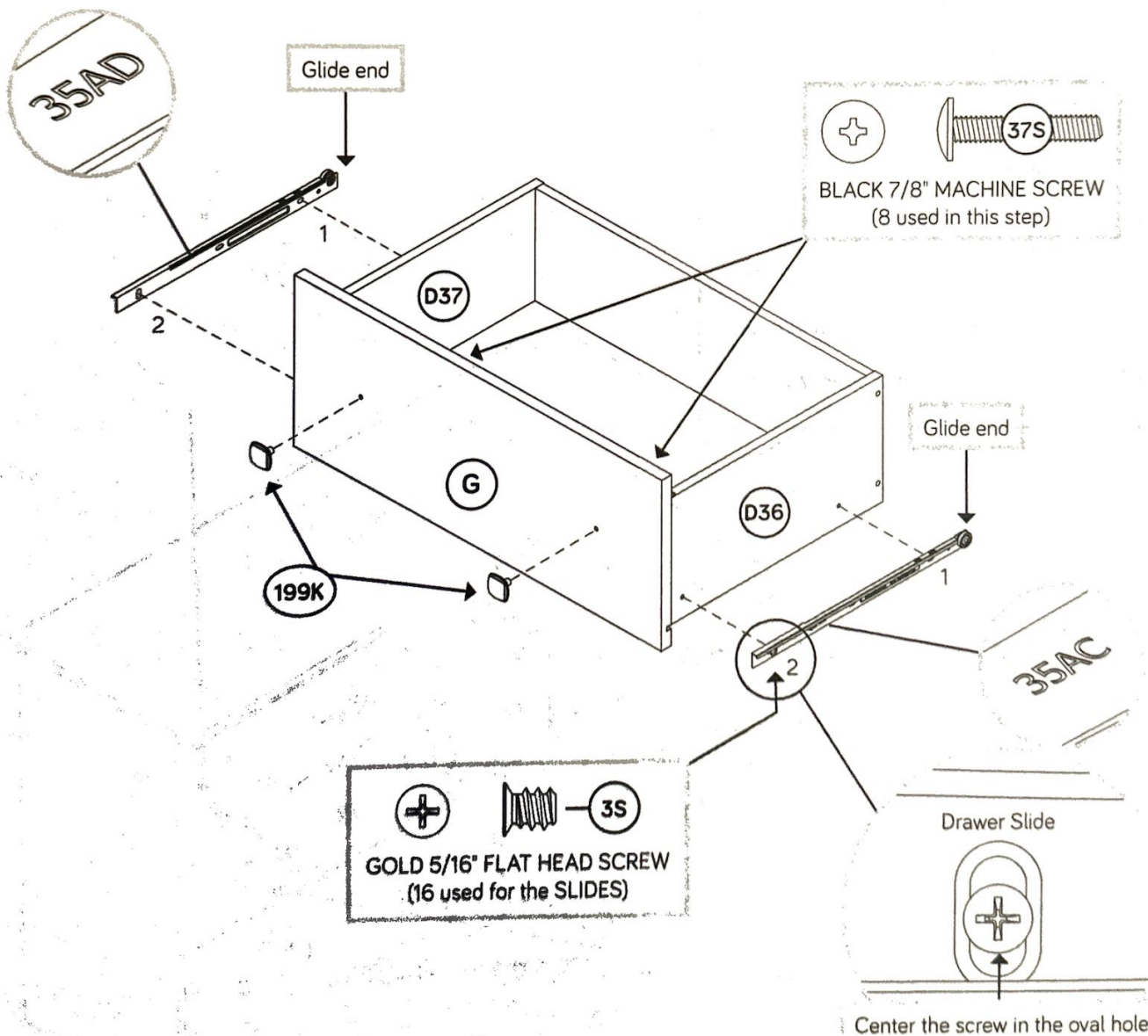



# Step 24

✚ To insert a drawer into your unit, tip the front of the drawer down and drop the glides on the drawer behind the glides on the unit. Lift the front of the drawer up and slide it into the unit.

✚ **NOTE:** Be sure the label on the SMALL LEFT DRAWER SIDE is in the UPPER left drawer as shown.

✚ Peel APPLIQUES from the APPLIQUE CARD (91P) and stick them onto each visible SCREW head.

✚ **NOTE:** Please read the back pages of the instruction booklet for important safety information.

✚ This completes assembly. Clean with a damp cloth. Wipe dry.

★ And to celebrate, why not share your success story at [sauder.com](http://sauder.com) or



## ⚠ WARNING



**Children have died from furniture tipover. To reduce the risk of furniture tipover:**

- ALWAYS install tipover restraint provided.
- NEVER put a TV on this product.
- NEVER allow children to stand, climb, or hang on drawers, doors, or shelves.
- NEVER open more than one drawer at a time.
- Place heaviest items in the lowest drawers.

*This is a permanent label.  
Do not remove!*



1/19

526119

Place the glide on the SLIDE behind the glide on the RAIL.

